

ASBESTOS MANAGEMENT PLAN REPORT

CDB PROJECT NUMBER -- 910-010-078

STEVENSON EXPRESSWAY

Illinois Department of Transportation
Maintenance Storage

CDB # D0139

Joliet Road and First Avenue
McCook, Cook County, Illinois, 60525

STATE OF ILLINOIS

CAPITAL DEVELOPMENT BOARD

SPRINGFIELD, ILLINOIS

BY:

CAPE ENVIRONMENTAL MANAGEMENT INC
91 NOLL STREET
WAUKEGAN, IL 60085
(847) 336-4341

DATE OF

SUBMITTAL: 6-11-99

DATE SIGNED: 6-11-99

EXP. DATE: 12-31-2000

(A/E LICENSE)

IDPH LICENSE 100-3516

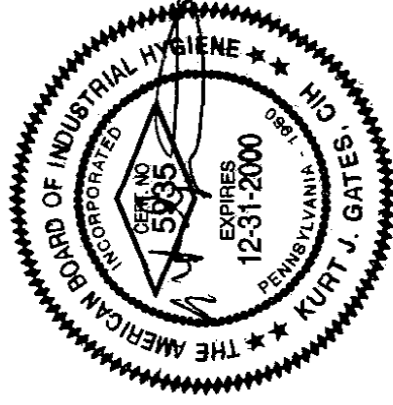
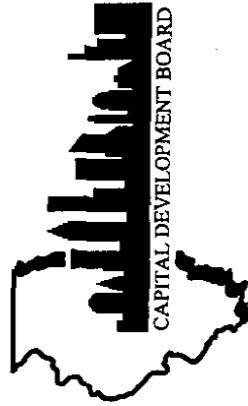

TABLE OF CONTENTS

<u>SECTION</u>	<u>PAGES</u>
I. Building Inventory	1
II. Introduction	1-4
III. Narrative	1-2
IV. Summary of Findings	1-3
V. Site Plan	1
VI. Floor Plan	1-5
VII. Inspection Report Form	
D0139 – Cement. Pipe Fitting Ins. on Dom. Water Sys. TJA	1-9
Lab Analysis	
Photos	
Response Action	
D0139 – 12"x12" Floor Tile/Mastic-White w/Blue Specs MFA	1-6
D0139 – Vibration Dampers MMA	1-6
D0139 – Baseboard Mastic MMB	1-6
D0139 – Transitite Ceiling Panels MTA	1-6
Photos	
Response Action	
D0139 – Cardboard Pipe Ins. on Dom. Water System TPA	1-7
D0139 – 2'x4' Ceiling Tile-Lay-in-Fissured Pattern MCA	1-7
Lab Analysis	
Photos	
VIII. Cost Summary	1
IX. Chain of Custody	1-2
X. Licenses and Accreditation's	1-9
XI. Appendix C O & M Plan	C1.1 – C11.9

CAPITAL DEVELOPMENT BOARD BUILDING INVENTORY FORM 3

C.D.B. BUILDING NUMBER: D0139 **BUILDING NAME:** Maintenance Storage

USING AGENCY: Illinois Department of Transportation **LOCATION:** Stevenson Expressway

BLDG. ADDRESS: Joliet Road and First Avenue **CITY:** McCook

ZIP: 60525 **COUNTY:** Cook **HOUSE/SENATE DISTRICT:** 047/24

YEAR	GROSS SQ. FT.	TOTAL FLOORS:	FLOORS BELOW GRADE:
1965	17,620	1	0

USE OF BUILDING WHEN CONSTRUCTED (C): Storage **CURRENT PRIMARY USE (P):** Storage **CURRENT SECONDARY USE (S):** N/A

PREDOMINATE CONSTRUCTION TYPE: Brick

FOR USING AGENCY USE ONLY:

BUILDING NOTE:

(FOR C.D.B. USE ONLY) ASBESTOS STATUS:

FORM 4

INTRODUCTION TO THE MANAGEMENT PLAN

A. Policy Statement

This Management Plan is intended to be a working document which will serve as a guide to staff, employees, occupants and visitors in minimizing the risk of exposure to asbestos fibers. The State of Illinois recognizes the serious health hazards associated with asbestos fibers. The State has conducted an inspection of this facility in order to determine whether asbestos is present, and if so, where the asbestos is located.

This Management Plan sets forth the recommended response actions for the ACM (asbestos containing material) within this facility. Further, where required, an Operations & Maintenance (O & M) Program has been established which will be implemented by facility staff.

This Plan has been reviewed by CDB, the Contracting Agency and the Using Agency and represents the policies and procedures to be implemented with respect to any ACM within this facility.

Dated: _____

Capital Development Board Representative

Dated: _____

Agency (Designated Person)

Dated: 3/22/99

Nicholas S. Bridgier
Management Planner

B. Applicable Standards

This Management Plan was developed in accordance with CDB's A/E Manual of Procedures for Asbestos Inspections and Management Plans. The IDPH Rules are the minimum standard referenced herein.

C. Asbestos as a Health Hazard

The adverse health effects of asbestos were first noted in the early 1900s. The early reports described asbestosis, a form of generalized scarring in the lungs, in workers occupationally exposed to asbestos. Later, in 1935, attention was also directed to lung cancer associated with asbestos exposure and, after a report from South Africa in 1960, it became apparent that exposure to asbestos was also associated with mesothelioma, a formerly very rare and unusual cancer of tissues lining the chest and abdominal cavity.

Currently, five important health effects have been associated with asbestos exposure. They are: lung cancer, mesothelioma, gastrointestinal cancer, asbestos related pleural disease, and asbestosis.

Lung Cancer - Lung cancer is now the most common cause of cancer in both men and women in the United States and cigarette smoking is clearly the major risk factor. Numerous epidemiological studies have demonstrated an unequivocal relationship of lung cancer with asbestos exposure in the workplace. Thirty-two studies of different occupationally exposed groups have demonstrated significant association between asbestos exposure and of lung cancer. Furthermore, an increase in asbestos exposure, expressed as concentration of asbestos fibers and duration of exposure in the workplace, appears to increase lung cancer rates. These data suggest that the dose response relationship is probably linear, but it is not yet known whether or not a threshold level of exposure exists below which no increased risk is found.

Of great importance is the observation that cigarette smoking appears to interact with asbestos in a multiplicative manner as to greatly increase the risk of developing lung cancer. Workplace asbestos exposure alone may increase the risk of lung cancer by 5 times. Asbestos exposure plus smoking, however, appears to increase the risk by about 50 times.

It has been shown that the greatest risk of developing lung cancer occurs at 20 or more years after the initial asbestos exposure. The existence of this latent period or lag time indicates that asbestos associated lung cancers will continue to occur in the future from exposures which happened in the past.

Mesothelioma - Mesothelioma is a cancer of the membranes lining the chest and abdominal cavity. Years ago, mesothelioma was a medical curiosity because it was so rare. When malignant mesothelioma is seen today, asbestos exposure is likely to have previously occurred.

The data linking asbestos exposure to mesothelioma is based upon many of the same epidemiological studies of workers that demonstrated an association between asbestos exposure and lung cancer. The findings are

somewhat different than for lung cancer. Lower non-occupational exposures have also been associated with mesothelioma in addition to occupational exposure. Therefore lower levels of exposure to asbestos as found in some non-occupational settings may give rise to mesothelioma. Secondly, the nature of the dose response relationship may be different from that of lung cancer. The risk continues to increase as the number of years since first exposure increases. In many cases, a latent period of more than 40 years has been described.

Gastrointestinal Cancer - Several of the epidemiological studies of workers occupationally exposed to asbestos have shown increased risks of gastrointestinal cancer including cancers of the colon, rectum, stomach and esophagus. The risk, however, does not appear to be as great as for lung cancer. To date, no association has been found between asbestos in drinking water and gastrointestinal cancer.

Asbestos Related Pleural Disease - This category of health effects includes fibrous and sometimes calcified plaques as well as diffuse thickening of the pleura and the pleural effusion. These are non-cancerous changes of the membranes surrounding the lungs and commonly occur many years after asbestos exposure. The presence of plaques suggests prior asbestos exposure but usually does not cause any symptoms or respiratory impairment.

Asbestosis - Asbestosis is a disabling lung disorder consisting of generalized scarring of the lungs which causes shortness of breath on exertion. Asbestosis has been described almost exclusively in workers with occupational exposure to high concentrations of asbestos-containing dusts. In asbestosis, there appears to be a very strong dose response relationship in that the greater the concentration of asbestos fibers, and the longer the duration of exposure, the greater the likelihood and severity of asbestosis.

As with the other asbestos related health effects, there is usually a time lag or latent period of several years before the development of disease. Once acquired, asbestosis tends to progress slowly, sometimes for years after asbestos exposure has ended.

ACCREDITATION OF MANAGEMENT PLANNER(S)

I, Nickolas Briglio, prepared or supervised the preparation of this Asbestos Management Plan for Maintenance Storage Building CDB #D0139 at the I.D.O.T Stevenson Expressway Facility.

I am licensed as a Management Planner by the State of Illinois and have attached verification of such below.

Signature: Nickolas S. Briglio Date: 3/22/99
IDPH LICENSE NO: 3516

IDPH IDENTIFICATION CARD
FRONT

State of Illinois A 86367
Department of Public Health
LICENSE, PERMIT, CERTIFICATION, REGISTRATION
ASBESTOS PROFESSIONAL LICENSE

EXPIRATION DATE	CATEGORY	I.D. NUMBER
05/15/99	5319	100-3516

NICKOLAS BRIGLIO
MANAGEMENT PLAN
PROJECT MANAGER
INSPECTOR AIR SAMPLING PROFESSIONAL

IDPH IDENTIFICATION CARD
BACK

THE PERSON, FIRM OR CORPORATION, WHOSE NAME APPEARS ON THIS CERTIFICATE HAS COMPLIED WITH THE PROVISIONS OF THE ILLINOIS STATUTES AND/OR RULES AND REGULATIONS AND IS HEREBY AUTHORIZED TO ENGAGE IN THE ACTIVITY INDICATED ON THE FACE OF THIS CARD.



ISSUED UNDER THE AUTHORITY OF
STATE OF ILLINOIS
DEPARTMENT OF PUBLIC HEALTH

SIGNATURE OF LICENSEE

Narrative

Cape Environmental Management Inc. (Cape) was contracted to conduct an Asbestos Survey at the Stevenson Expressway Illinois Department of Transportation Facility, located in McCook, Illinois.

The Illinois Department of Transportation Facility contains numerous buildings, which have various uses. Included in this report is asbestos survey information for the Maintenance Storage, CDB#D0139.

Cape performed the inspection phase of the asbestos survey on December 18, 1998. The building was constructed in 1965. In 1994, the roof was reconstructed. In 1996, pipe insulation on radiant heating system was removed. No other major renovations have taken place in the building.

The building is a two-story structure consisting of 17,620 square feet used as storage and office space. When in use, 10 people occupy the building. The building was constructed of brick. The roof was constructed of metal and is in good condition. Heating is supplied to the building by radiant heat.

The following suspect asbestos-containing materials were identified in the building:

- Cementitious Pipe Fitting Insulation on Domestic Water System
- Cardboard Pipe Insulation on Domestic Water System
- 2'x4' Ceiling Tile – Lay-in – Fissured Pattern
- 12"x12" Floor Tile/Mastic – White with Blue Specs
- Vibration Dampers
- Baseboard Mastic
- Transite Ceiling Panels

The Sampling Phase was performed on December 18, 1998. A total of nine (9) samples were collected from three (3) homogenous areas. Three (3) of the samples contained asbestos. The samples were analyzed by a NVLAP and CDB approved laboratory. The following materials were identified as asbestos-containing from laboratory analysis:

- Cementitious Pipe Fitting Insulation on Domestic Water System

The building contains 12"x12" Floor Tile/Mastic, Vibration Dampers, and Baseboard Mastic, and Transite Ceiling Panels, which are assumed to be asbestos-containing. These materials in the building are not damaged and are considered by the CDB to no pose a hazard.

The following tabs present our findings for the Inspection Phase, Sampling Phase, and Management Plan of this facility. The format of this report is based on the Illinois Capital Development Board A/E Manual of Procedures for Asbestos, Inspection, and Management Plans. Additionally, determination of homogenous areas and suspect materials is also based on the A/E Manual of Procedures as well as clarifications received from CDB.

The Management Plan was completed on March 19, 1999.

DECISION TREE

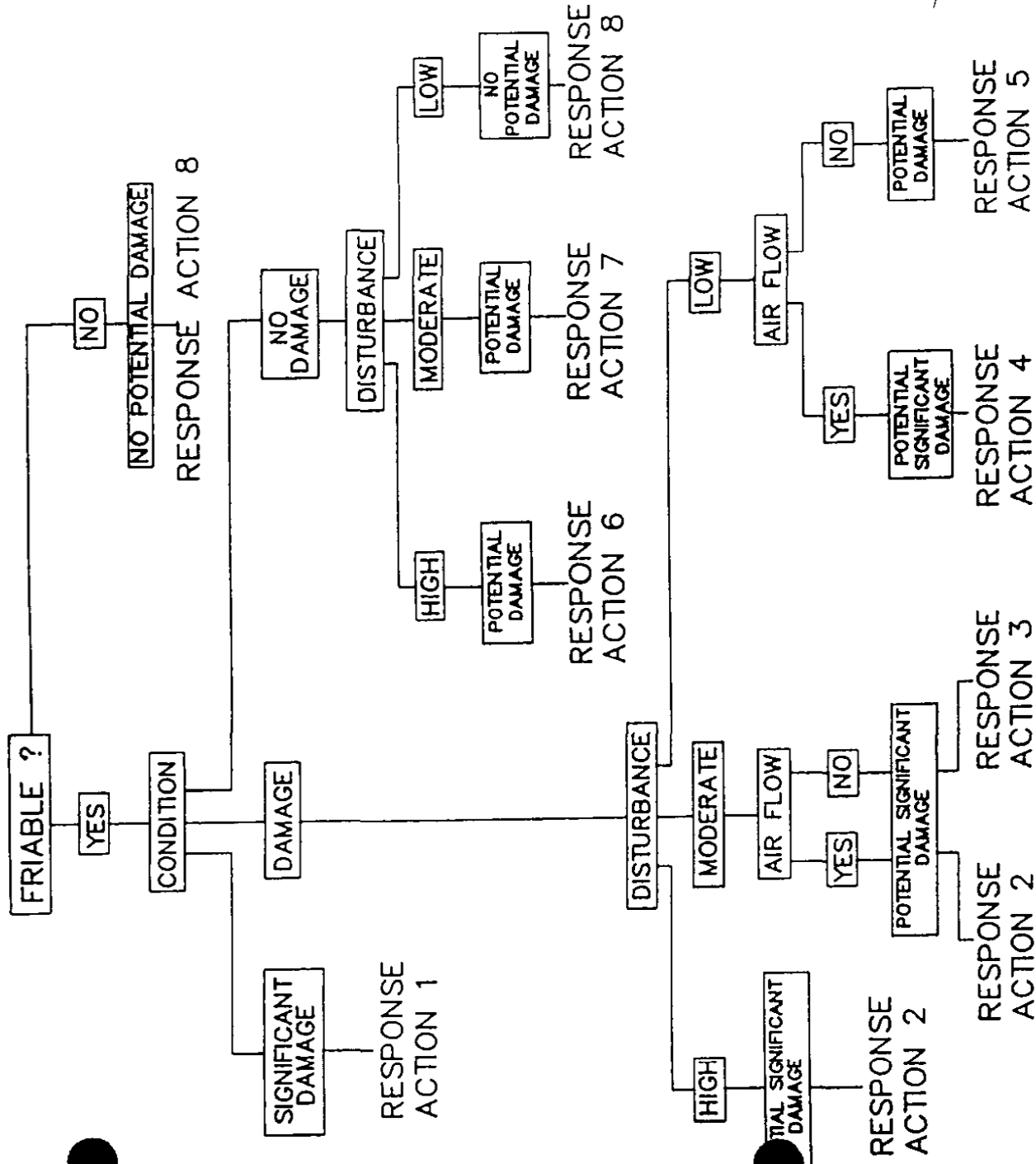

RESPONSE ACTIONS KEY

1. Isolate area and restrict access. Remove as soon as possible.
2. Continue O & M. Remove as soon as possible or repair and reduce potential for disturbance.
3. Continue O & M. Schedule removal when practical and cost-effective, or reduce disturbance.
- 4-5. Continue O & M. Schedule removal when practical and cost-effective, number indicates priority for removal.
- 6-7. Continue O & M. Take preventive measures to reduce disturbance. Number indicates priority for removal.
8. Continue O & M until major renovation or demolition requires removal under NESHAP, or until hazard assessment factors change.

Note: An O & M program may include enclosure and encapsulation, where appropriate to increase the effectiveness of O & M. Removal is always an option by the owner.

SUMMARY OF FINDINGS

Inspection Phase I

Facility Name: Illinois Department of Transportation – Stevenson Expressway
 CDB Bldg. Name & Number: Maintenance Storage CDB# D0139
 CDB Project Number: 910-010-078

HOMOGENEOUS AREA	DESCRIPTION	QUANTITY	NUMBER SAMPLES RECOMMENDED	REMOVAL*
TJA	Cementitious Pipe Fitting Insulation on Domestic Water System	30 Each	3	< \$25,000
MFA	12"x12" Floor Tile/Mastic -- White with Blue Specs	900 SF	0 – Assumed	< \$25,000
MMA	Vibration Dampers	2 Each	0 – Assumed	< \$25,000
MMB	Baseboard Mastic	550 LF	0 – Assumed	< \$25,000
MTA	Transite Ceiling Panels	32 SF	0 – Assumed	< \$25,000
TPA	Cardboard Pipe Insulation on Domestic Water System	750 LF	3	< \$25,000
MCA	2'x4' Ceiling Tile – Lay-in – Fissured Pattern	500 SF	3	< \$25,000

* Removal cost if suspect material is determined to be asbestos.

LF – Linear Feet

SF – Square Feet

SUMMARY OF FINDINGS

Sampling Phase II

Facility Name Illinois Department of Transportation -- Stevenson Expressway
 CDB Bldg. Name & Number Maintenance Storage CDB # D0139
 CDB Project Number 910-010-078

HOMOGENEOUS AREA	DESCRIPTION	ACM			NOTES
		ASSUMED	POS	NEG	
D0139 - TJA	Cementitious Pipe Fitting Insulation on Domestic Water System		3		
D0033 - MFA	12" x 12" Floor Tile/Mastic - White with Blue Specs	X			
D0139 - MMA	Vibration Dampers	X			
D0139 - MMB	Baseboard Mastic	X			
D0139 - MTA	Transite Ceiling Panels	X			
D0139 - TPA	Cardboard Pipe Insulation on Domestic Water System			3	
D0033 - MCA	2' x 4' Ceiling Tile - Lay - in Fissured Pattern			3	

FORM 6 SUMMARY OF FINDINGS

C.D.B. PROJ. NO.

910-010-078

BUILDING NAME

Maintenance Storage

C.D.B. BUILDING NUMBER

D0139

MANAGEMENT PLAN PHASE III

LIST IN ORDER OF RESPONSE ACTIONS NUMBER

DAMAGE ASSESSMENT		MATERIAL DESCRIPTION	TJA	MFA	MMA	MMB	MTA
RESPONSE ACTION	DESCRIPTION (I.E. REMOVE, REPAIR, ENCLOSE, ENCAPSULATE, OR O & M)						
ACM CONTENT (%)			5-10%				
	CHRYSOPILE						
	AMOSITE						
	OTHER						
	ASSUMED ACM						
	NO DAMAGE		X	X	X	X	X
	SALIENT						
	DAMAGE						
	SIGNIFICANT DAMAGE						
	NO POTENTIAL DAMAGE						
	POTENTIAL DAMAGE						
	POTENTIAL SIGNIFICANT DAMAGE						
	NUMBER		8	8	8	8	8
			O & M	O & M	O & M	O & M	O & M

FACILITY KEY

D0139	MAINTENANCE STORAGE
D0140	MAINTENANCE STORAGE
D0145	SALT DOME
D0146	FUEL SERVICE BUILDING
D0147	EQUIPMENT STORAGE
D0149	PROPANE STORAGE

D0145

D0139

FIRST AVENUE

D0146

D0147

D0149

D0140

JOLIET ROAD

STEVENSON EXPRESSWAY
SITE PLAN
SCALE: 1" = 50'-0"



GRAPHIC SCALE

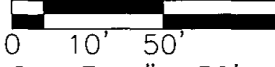

SCALE: 1" = 50'

ILLINOIS DEPARTMENT OF TRANSPORTATION
STEVENSON EXPRESSWAY

CDB BUILDING NAME: MAINTENANCE STORA
CDB BUILDING NUMBER: D0139

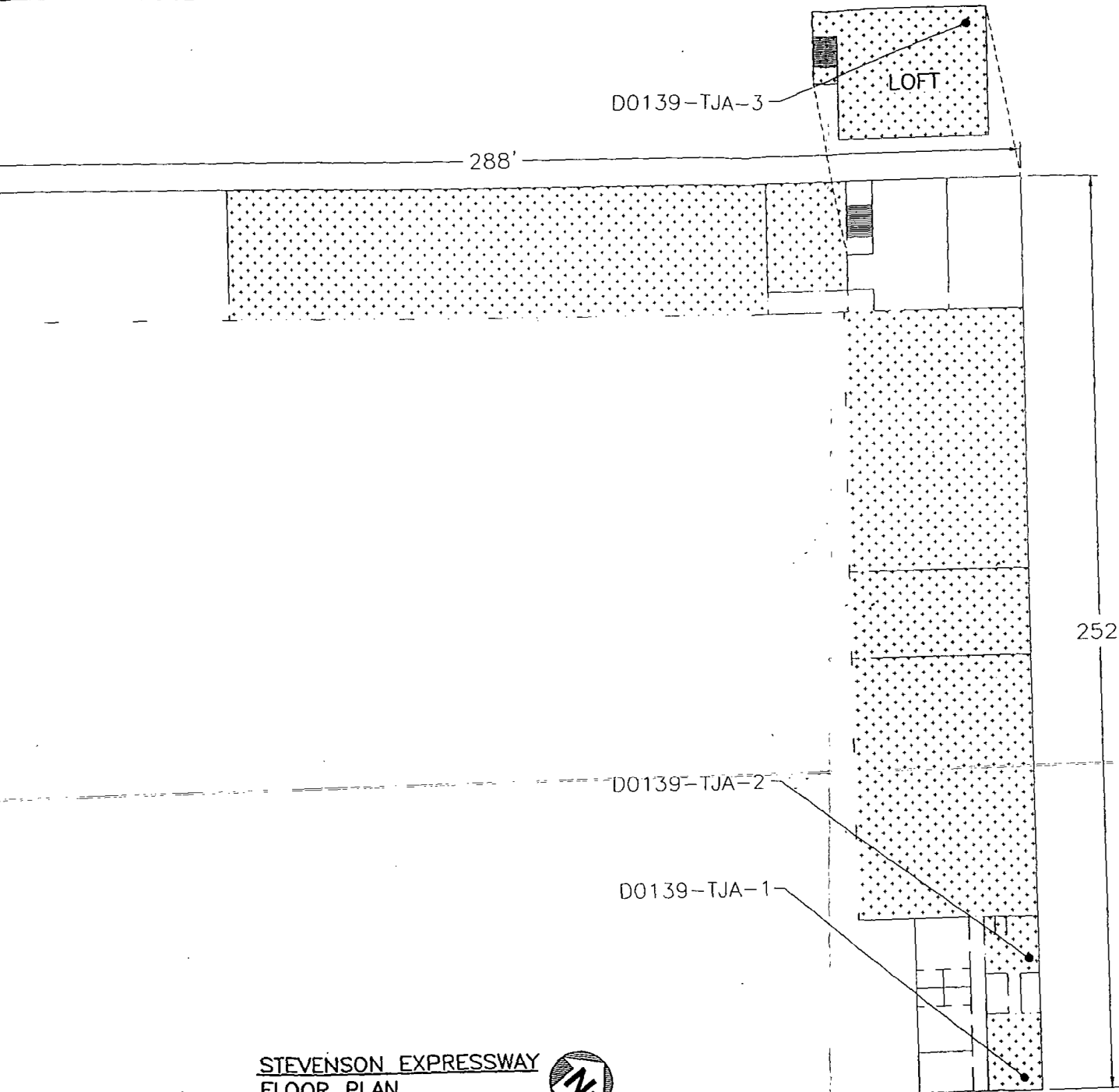

LEGEND

 HOMOGENEOUS AREA: TJA
CEMENTITIOUS PIPE FITTING INSULA
ON DOMESTIC WATER SYSTEM
Response Action Pages 8-9

GRAPHIC SCALE

0 32' 64'



SCALE: 1/32" = 1'-0"

STEVENSON EXPRESSWAY
FLOOR PLAN
SCALE: 1/32" = 1'-0"



CAPITAL DEVELOPMENT BOARD
PROJECT #910-010-078

ILLINOIS DEPARTMENT OF TRANSPORTATION
STEVENSON EXPRESSWAY

CDB BUILDING NAME: MAINTENANCE STOR.
CDB BUILDING NUMBER: D0139

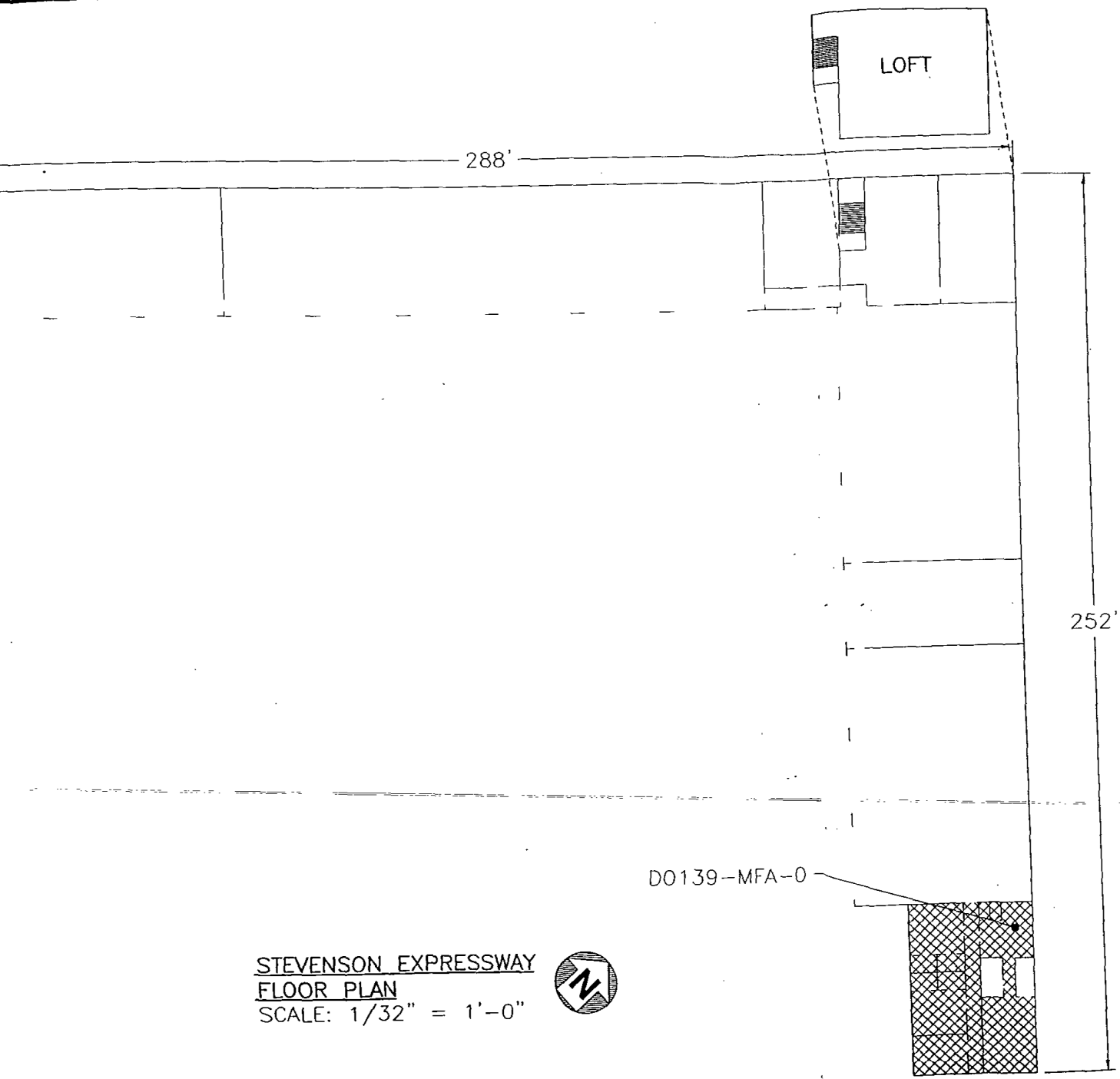

STEVENSON EXPRESSWAY
FLOOR PLAN
SCALE: 1/32" = 1'-0"



LEGEND

 HOMOGENEOUS AREA: MF
12"X12" FLOOR TILE/MA
WHITE WITH BLUE SPECS
Response Action Pages 5-6

GRAPHIC SCALE

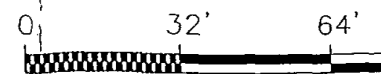

SCALE: 1/32" = 1'-0"

CAPITAL DEVELOPMENT BOARD
PROJECT #910-010-078

ILLINOIS DEPARTMENT OF TRANSPORTATION
STEVENS ON EXPRESSWAY

CDB BUILDING NAME: MAINTENANCE ST
CDB BUILDING NUMBER: D0139

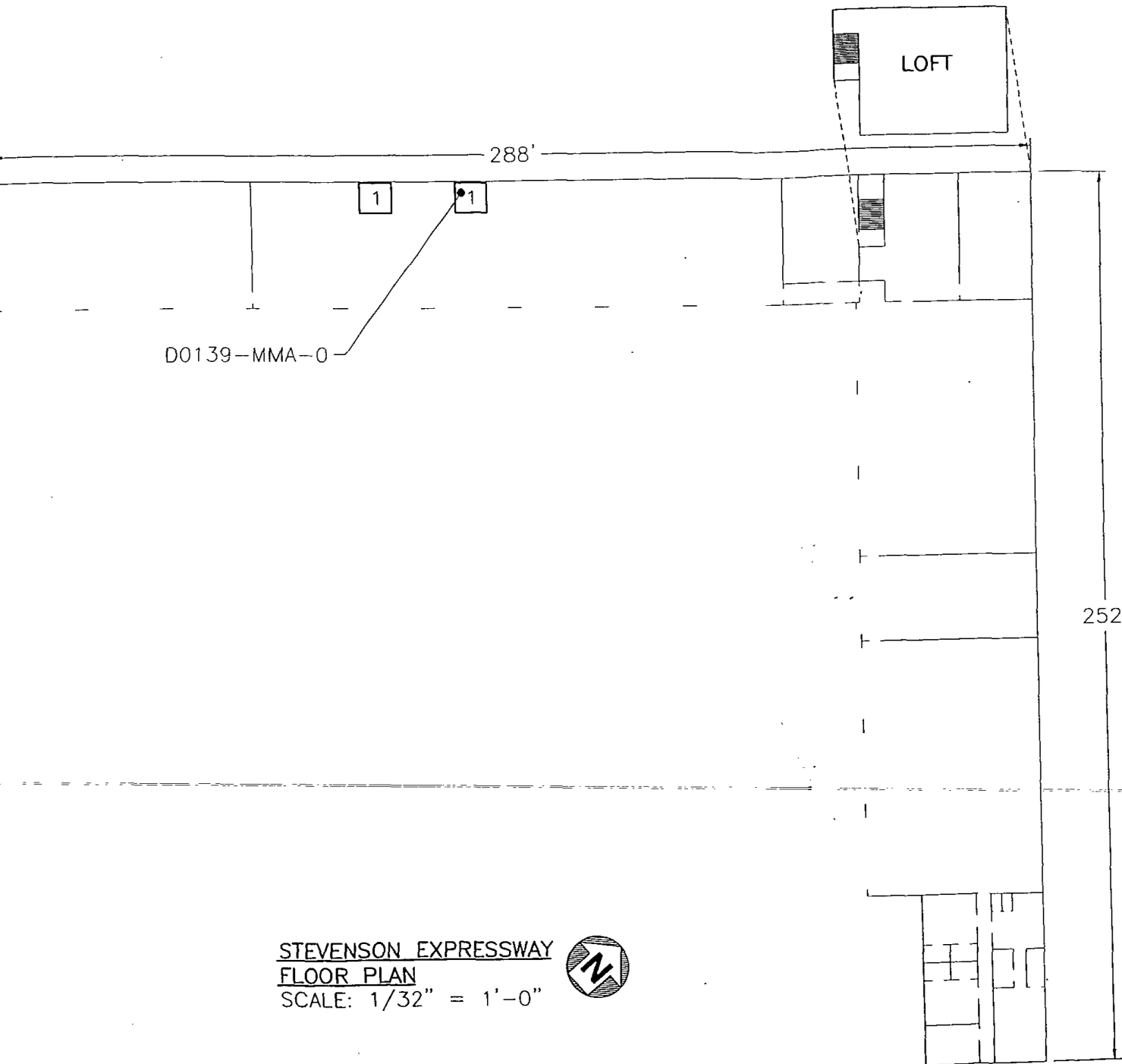

STEVENS ON EXPRESSWAY
FLOOR PLAN
SCALE: 1/32" = 1'-0"



LEGEND

1 HOMOGENEOUS AREA: M
VIBRATION DAMPERS
Response Action Pages 5-6

GRAPHIC SCALE

0 32' 64'





SCALE: 1/32" = 1'-0"

CAPITAL DEVELOPMENT BOARD
PROJECT #910-010-078

ILLINOIS DEPARTMENT OF TRANSPORTATION
STEVENSON EXPRESSWAY

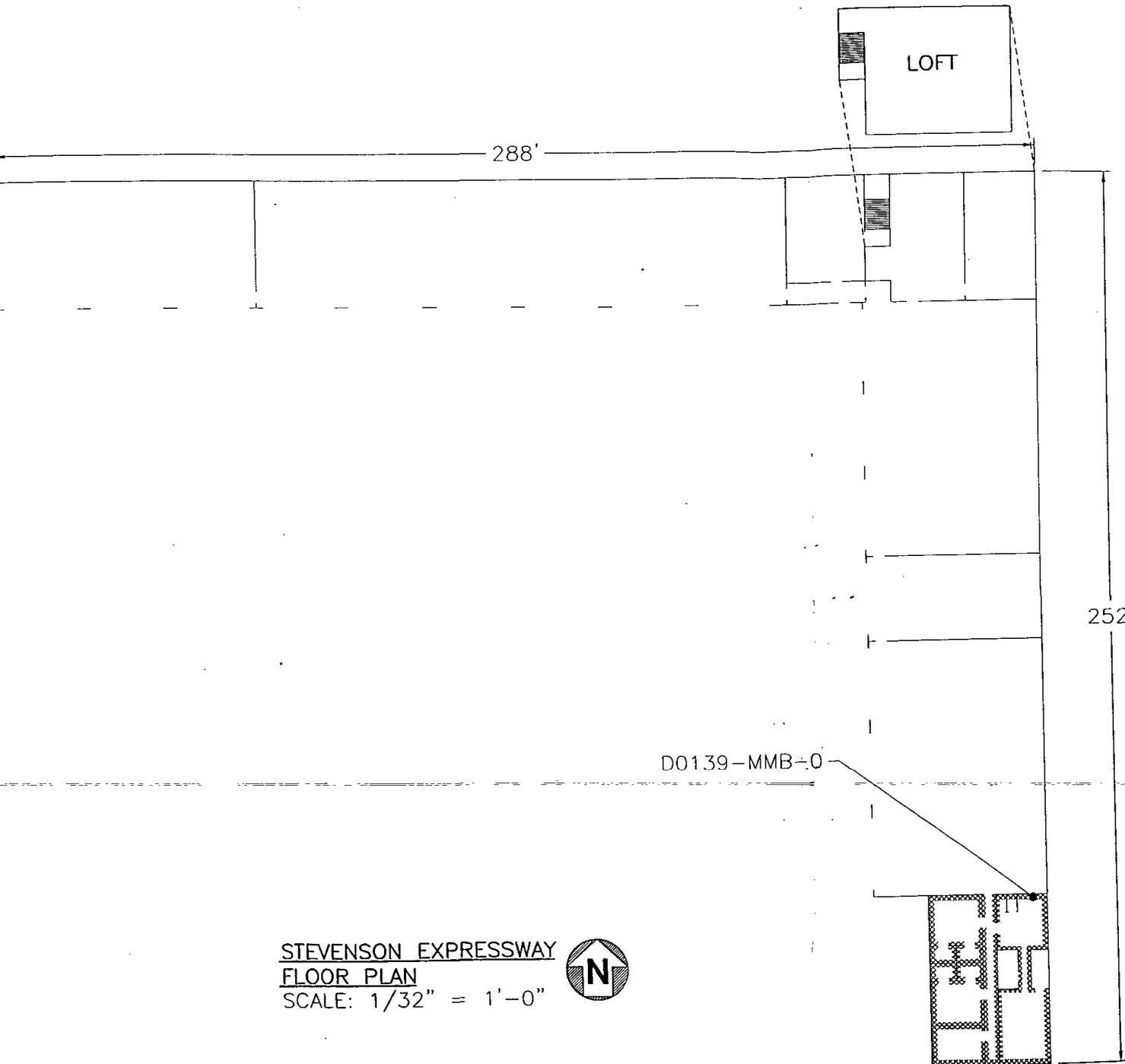
CDB BUILDING NAME: MAINTENANCE ST
CDB BUILDING NUMBER: D0139



STEVENSON EXPRESSWAY
FLOOR PLAN
SCALE: 1/32" = 1'-0" 

LEGEND

 HOMOGENEOUS AREA: M
BASEBOARD MASTIC
Response Action Pages 5-6

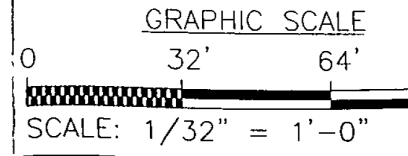

CAPITAL DEVELOPMENT BOARD
PROJECT #910-010-078

ILLINOIS DEPARTMENT OF TRANSPORTATION
STEVENSON EXPRESSWAY

CDB BUILDING NAME: MAINTENANCE ST
CDB BUILDING NUMBER: D0139

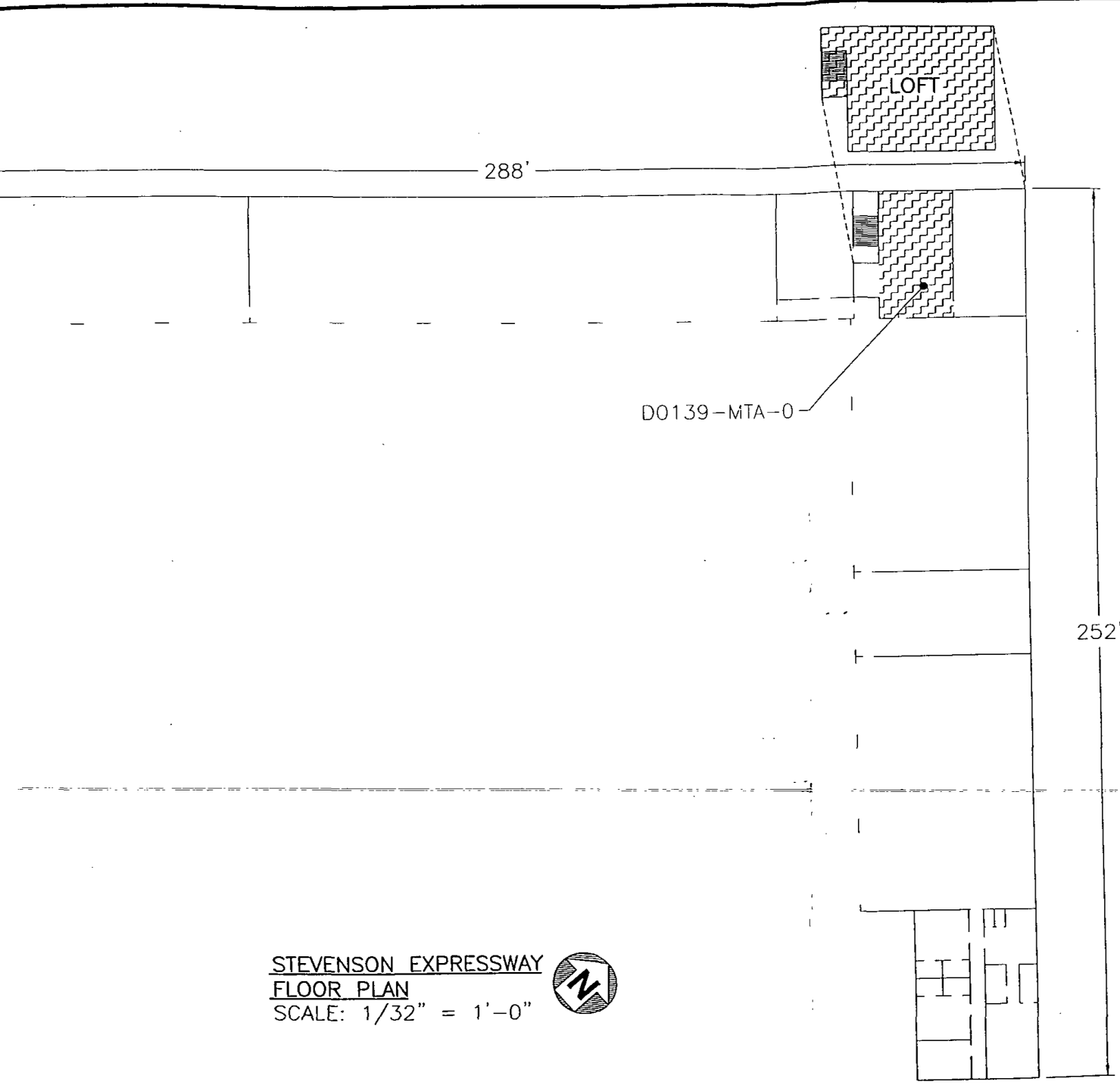

STEVENSON EXPRESSWAY
FLOOR PLAN
SCALE: 1/32" = 1'-0"



LEGEND

 HOMOGENEOUS AREA:
TRANSITE CEILING PANELS
Response Action Pages 5-6

GRAPHIC SCALE

0 32' 64'



SCALE: 1/32" = 1'-0"

CAPITAL DEVELOPMENT BOARD
PROJECT #910-010-078

FORM 9

HOMOGENEOUS AREA INSPECTION REPORT

CDB Building #:

D0139 Homogeneous Area TJA

INSPECTION DATE:

12-18-98 CDB PROJECT NO. 910-010-078

CONTROLLING AGENCY:
FACILITY

Illinois Department of Transportation
Stevenson Expressway

BUILDING NAME:

Maintenance Storage

BUILDING ADDRESS

Joliet Road and First Avenue

A/E FIRM

Cape Environmental Management Inc

INSPECTOR

Daniel Goff IDPH LICENSE NO. 100-8428

LOCATION

McCook, Illinois

ROOMS

Washroom, Locker Room, Bays 2-5, Storeroom

MATERIAL DESCRIPTION:
(common designation - i.e. air cell)

Pipe Fitting Insulation - Magnesia Type

TYPE OF SYSTEM:
(i.e. hot water)

Domestic Water System

COLOR, TEXTURE, ETC.:

White

FRIABLE:

Yes No Pipe Diameter: 2 Inches

TOTAL QUANTITY

Sq. ft. 30 Lin Fl. 30 Ea.

QUANTITY IN:

Occupied: 30 Restricted Unoccupied

ROOM FINISHES:

CEILING
WALLS
FLOOR

Drywall, No Finish
Concrete
Concrete, Floor Covering

DAMAGE ASSESSMENT:

LOCALIZED OR
DISTRIBUTED

No Damage Damaged Significant Damage
<1% 1-25% >25%
<1% 1-10% >10%
If <1% damage, is salient present? Yes No
If yes, describe

WATER DAMAGE

Yes No Description

PHYSICAL DAMAGE

Yes No Description

AGE DETERIORATION



Yes No Description

ILLINOIS DEPARTMENT OF TRANSPORTATION
STEVENSON EXPRESSWAY

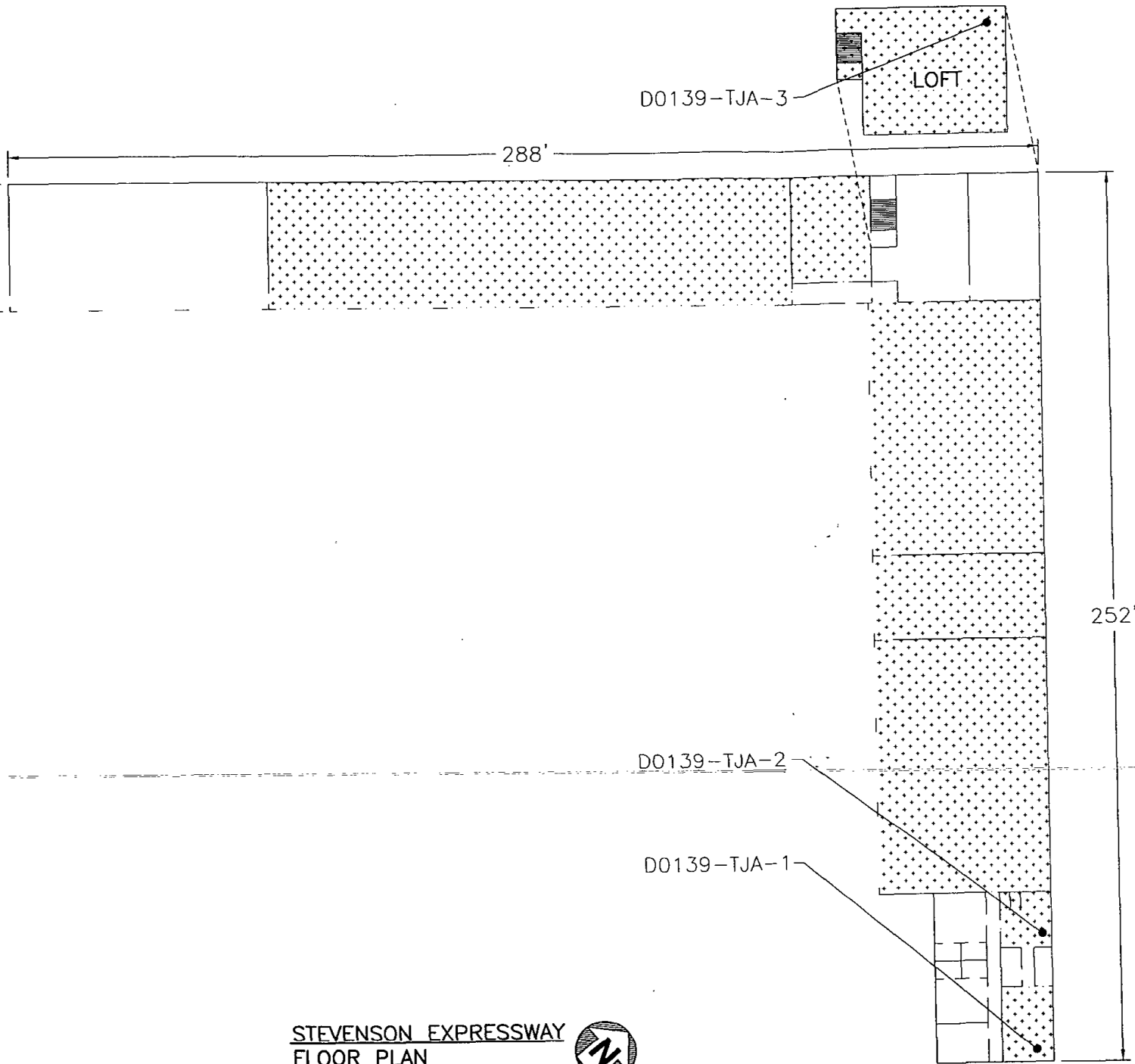
CDB BUILDING NAME: MAINTENANCE
CDB BUILDING NUMBER: D0139



LEGEND

 HOMOGENEOUS AREA: TJA
 CEMENTITIOUS PIPE FITTING
 ON DOMESTIC WATER SYSTEM

GRAPHIC SCALE

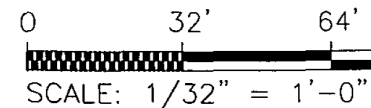

STEVENSON EXPRESSWAY
FLOOR PLAN
SCALE: 1/32" = 1'-0"



CAPITAL DEVELOPMENT BOARD
PROJECT #910-010-078

FORM 9 -- Page 2

CDB BUILDING #: D0139

Homogeneous Area: TJA

DISTURBANCE FACTORS
ACCESSIBLE TO OCCUPANTS
MAINTENANCE PERSONNEL
HEIGHT FROM FLOOR
AREA ABOVE
AREA ADJACENT
OCCUPANCY (#)
FREQUENCY OF USE (Hrs.)
UTILIZATION OF AREA

Yes	<input checked="" type="checkbox"/>	No	<input type="checkbox"/>
Yes	<input checked="" type="checkbox"/>	No	<input type="checkbox"/>
6	<u>6</u>	Ft.	
Roof			
N/A			
0	<u>1-2</u>	<u>3-10</u>	<input checked="" type="checkbox"/> <u>10+</u>
0	<u>1-2</u>	<u>3-10</u>	<input checked="" type="checkbox"/> <u>10+</u>
Office, Storage, Restroom			

SERVICEABLE COMPONENTS

(distance in ft. to)					
ELECTRICAL	<1	<u>1-5</u>	<input checked="" type="checkbox"/> >5	VIBRATION	Yes <input type="checkbox"/> No <input checked="" type="checkbox"/>
MECHANICAL	<1	<u>1-5</u>	<input checked="" type="checkbox"/> >5	MECHANICAL (MOTOR)	Yes <input type="checkbox"/> No <input checked="" type="checkbox"/>
PIPING	<1	<u>1-5</u>	<input checked="" type="checkbox"/> >5	PLUMBING (KNOCKING)	Yes <input type="checkbox"/> No <input checked="" type="checkbox"/>
OTHER	<1	<u>1-5</u>	<input type="checkbox"/> >5	OTHER	Yes <input type="checkbox"/> No <input checked="" type="checkbox"/>

BARRIER
SUSPENDED CEILING
ENCAPSULATION
ENCLOSURE
OTHER
AIR MOVEMENT
IF YES

Yes	<input type="checkbox"/>	No	<input checked="" type="checkbox"/>
Yes	<input type="checkbox"/>	No	<input checked="" type="checkbox"/>
Yes	<input type="checkbox"/>	No	<input checked="" type="checkbox"/>
Yes	<input type="checkbox"/>	No	<input checked="" type="checkbox"/>
Yes	<input type="checkbox"/>	No	<input checked="" type="checkbox"/>
Yes	<input checked="" type="checkbox"/>	No	<input type="checkbox"/>
Low	<input checked="" type="checkbox"/>	Moderate	<input type="checkbox"/>
		Heavy	<input type="checkbox"/>

DISTANCE TO FRIABLE MATERIAL

EXTERIOR DOOR
EXHAUST FAN
GRAVITY VENT
SUPPLY AIR
RETURN AIR
OTHER

Yes	<input checked="" type="checkbox"/>	No	<input type="checkbox"/>
Yes	<input type="checkbox"/>	No	<input checked="" type="checkbox"/>
Yes	<input type="checkbox"/>	No	<input checked="" type="checkbox"/>
Yes	<input type="checkbox"/>	No	<input checked="" type="checkbox"/>
Yes	<input type="checkbox"/>	No	<input checked="" type="checkbox"/>
Yes	<input type="checkbox"/>	No	<input checked="" type="checkbox"/>

INSPECTOR'S ASSESSMENT

No Potential for Damage Potential for Damage
Potential for Significant Damage

EXPLANATION OF

The material is not damaged. Material should remain in an undamaged state presuming compliance with

ASSESSMENT (REQUIRED)

the O & M program.

DAMAGE PREVENTION

N/A

MEASURE

COMMENTS

INSPECTOR'S SIGNATURE

[Signature]

DATE 3-22-99

SAMPLE NUMBERS

TJA-1, TJA-2, TJA-3

(Sampling Phase)

ACBM

Yes No

Assumed

FORM 11

BULK SAMPLE LABORATORY ANALYSIS REPORT

1. FACILITY: IDOT-Stevenson Expressway 2. CDB BUILDING #: D0139
 BUILDING: Maintenance Storage 4. CLIENT (A/E): CAPE ENVIRONMENTAL
 ADDRESS: Joliet Road & First Avenue 6. PROJECT #: 910-010-078

7. HOMOGENEOUS AREA (ONLY 1 PER FORM) TJA
 (A/E COMPLETE ITEMS 1-10 & PROVIDE TO LABORATORY.)

8. Location	Maintenance Storage	Maintenance Storage	Maintenance Storage
9. Date Collected	12/17/98	12/17/98	12/17/98
10. Sample No.	TJA-01	TJA-02	TJA-03
11. Date Received	1/29/99	1/29/99	1/29/99
12. Lab Sample No.	201665-01	201665-02	201665-03
13. Color?	GRAY	GRAY	GRAY
14. Fibrous?	YES	YES	YES
15. Layers?	1	1	1
16. Contains Asbestos?	YES	YES	YES
17. TYPE AND % ASBESTOS			
Chrysotile	5-10%	5-10%	5-10%
Amosite			
Crocidolite			
Other			
Total Asbestos %			
18. OTHER MATERIAL %			
Fibrous Glass	1-5%	1-5%	1-5%
Cellulose	5-10%	5-10%	5-10%
Synthetic Fibers			
Gypsum			
Calcite			
Quartz			
Perlite			
Vermiculite			
Others (BINDER)	75-80%	75-80%	75-80%
19. Date Analyzed	2/2/99	2/2/99	2/2/99
20. Analyzed By	Albio Marquez	Albio Marquez	Albio Marquez

All samples analyzed by polarized light microscopy with dispersion staining.

21. Report Approved By:  22. Date: 2/2/1999

Laboratory Name: STAT ANALYSIS

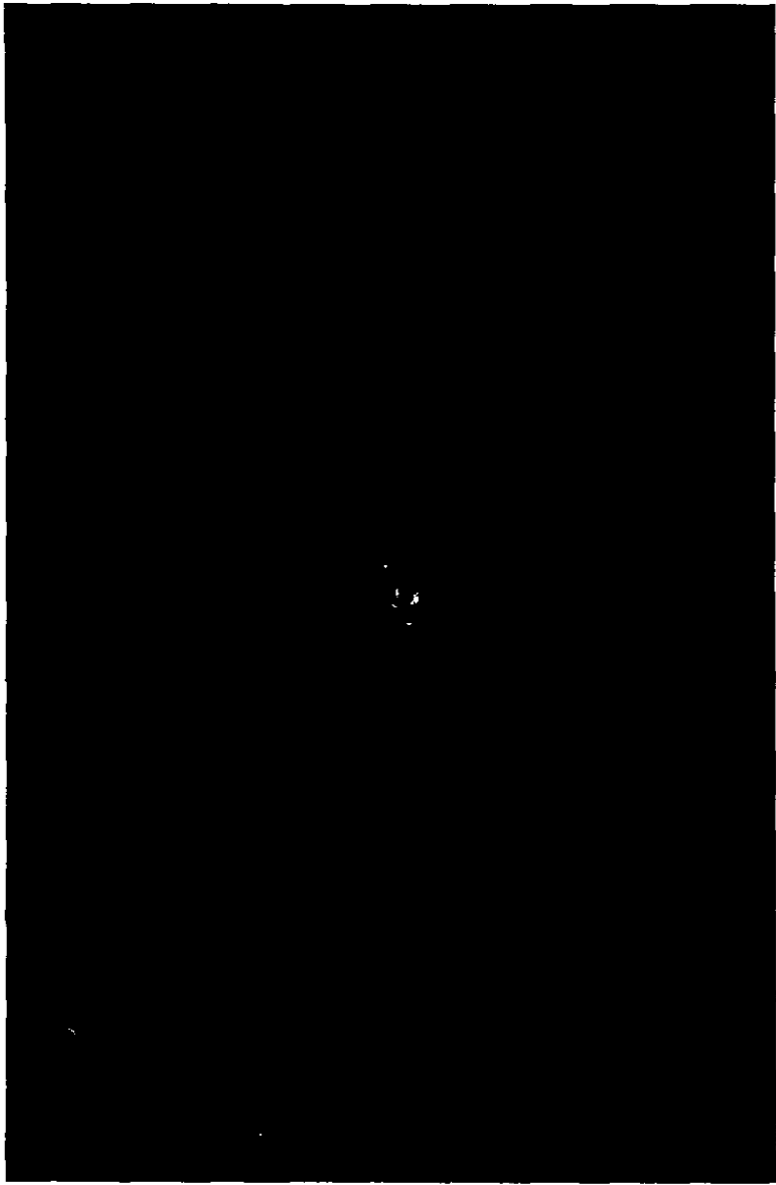

Illinois Department of Transportation
Stevenson Expressway - Maintenance Storage
D0139 - TJA - 1
CEMENTITIOUS PIPE FITTING INSULATION ON
DOMESTIC WATER SYSTEM
December 18, 1998

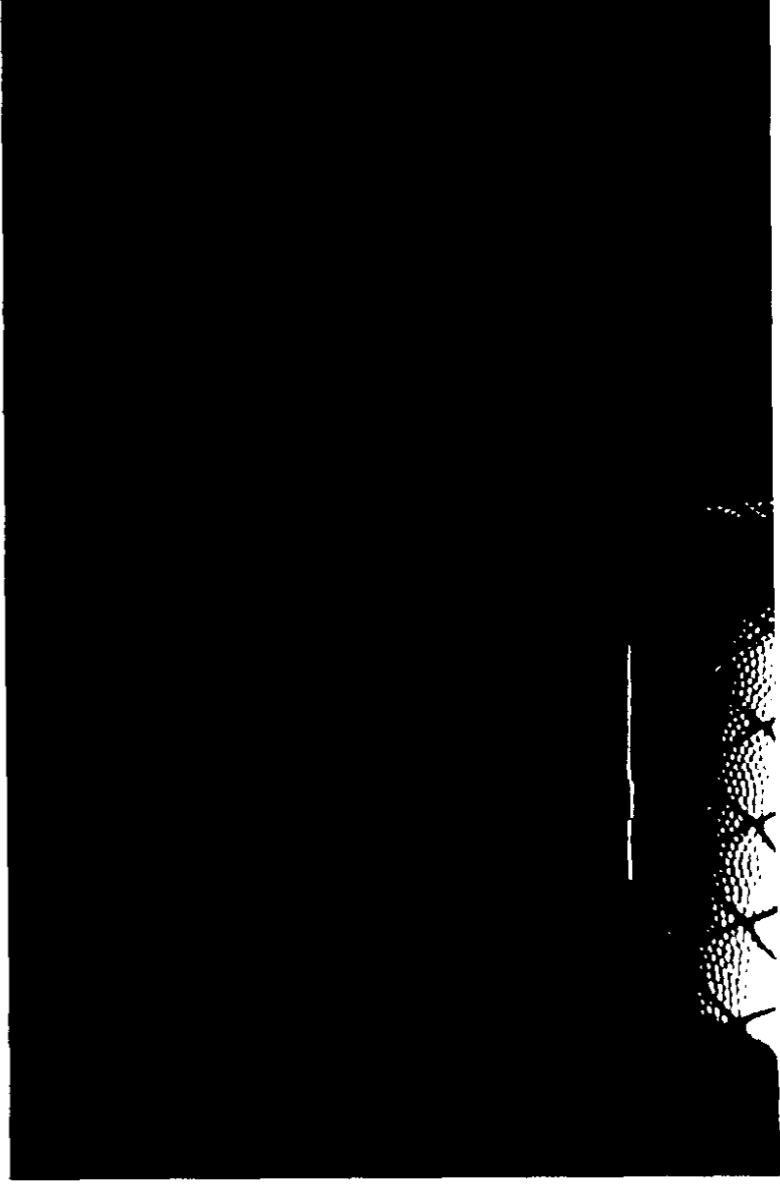

Illinois Department of Transportation
Stevenson Expressway – Maintenance Storage
D0139 – TJA – 2
CEMENTITIOUS PIPE FITTING INSULATION ON
DOMESTIC WATER SYSTEM
December 18, 1998

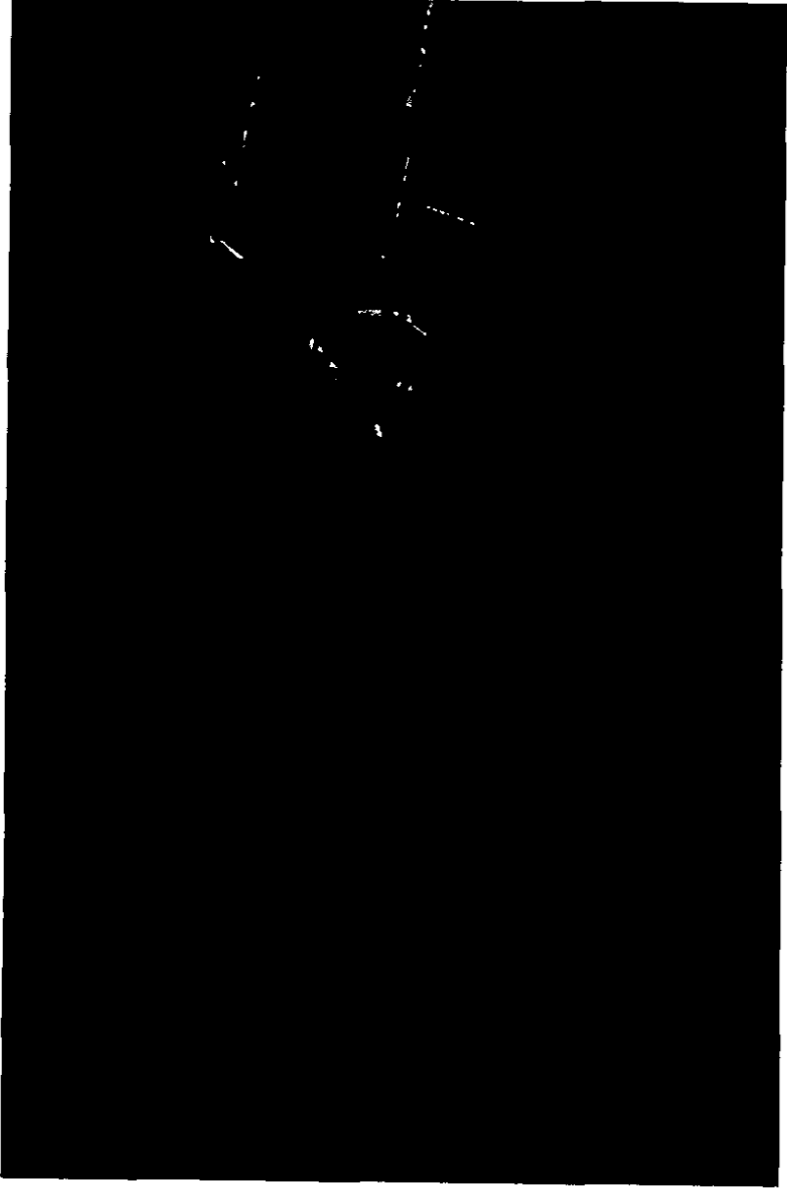

Illinois Department of Transportation
Stevenson Expressway - Maintenance Storage
D0139 - TJA - 3
CEMENTITIOUS PIPE FITTING INSULATION ON
DOMESTIC WATER SYSTEM
December 18, 1998

FORM 13

A.1 BLDG NAME : Maintenance Storage CDB BLDG NO. D0139
HOMOGENEOUS AREA : TJA DESCRIPTION: Cement Pipe Fitting Ins. on Dom. Water System
QUANTITY: 30 each

RESPONSE ACTION : 8

A.2.a. EXIST. COND. No Damage

POT. FOR DAMAGE : No Potential for Damage

A.2.b. FRIABLE : _____ CONDITION : No Damage
DISTURBANCE : No Potential for Disturbance AIR FLOW : No

A.3.a (1) WHY : Based on normal use and occupancy there is no potential for damage presuming compliance with the O & M program.

A.3.a (2) Preventative Measures : Follow O & M Program

A.3.b O & M Procedures : Follow O & M Program

A.3.c. Health and Safety : Post warning signs and only allow trained personnel using protective equipment to enter areas.

A.4 Cost Estimate

A.4.a Unit Cost for Removal of ACM : $\$100.90 \times 30$ (each) = $\$3,027.00$

Type and Replacement of Non-ACM Material : Pipe Fitting Insulation @ \$2.00 each = \$60.00

Design Fee : \$1,000.00

Time Required for Removal (Days) : 25 days

APM/ASP Unit Cost (Daily Rate) : \$500.00 x 25 days = \$12,500.00

Cost Per Sample : 175 samples at \$20.00 = \$ 3,500.00

Indemnification Factor (%) : 5% (\$1,004.35)

Total Cost : \$ 21,091.35

A.4.b Cost of Recommended Response Action (O&M): \$100.00

A.4.c O&M Cost Estimate

Inspection and Administration by Designated Person 2 times per year

A.4.d Special Conditions

Relocation of occupants during construction (2.5% of total cost)

FORM 9

HOMOGENEOUS AREA INSPECTION REPORT

CDB Building #:

D0139 Homogeneous Area MFA

INSPECTION DATE:

12-18-98 CDB PROJECT NO. 910-010-078

CONTROLLING AGENCY:
FACILITY

Illinois Department of Transportation
Stevenson Expressway

BUILDING NAME:

Maintenance Storage

BUILDING ADDRESS

Joliet Road and First Avenue

A/E FIRM

Cape Environmental Management Inc

INSPECTOR

Danial Gott IDPH LICENSE NO. 100-8428

LOCATION

McCook, Illinois

ROOMS

Washroom, Locker Room, Offices, Restrooms, Closets, Hallways

MATERIAL DESCRIPTION:
(common designation - i.e. air cell)

12" x 12" Floor Tile and Mastic

TYPE OF SYSTEM:
(i.e. hot water)

Flooring

COLOR, TEXTURE, ETC.:

White with Blue Specs

FRIABLE:

Yes No Pipe Diameter: _____ Inches

TOTAL QUANTITY

2,200 Sq. ft. _____ Lin Ft. _____ Ea.

QUANTITY IN:

Occupied: _____ Restricted _____ Unoccupied _____

ROOM FINISHES:

CEILING
WALLS
FLOOR

2x4 Ceiling Tile
Concrete
Floor Covering

DAMAGE ASSESSMENT:

LOCALIZED OR
DISTRIBUTED

No Damage
<1% 1-25% _____ Significant Damage
<1% 1-10% _____ >25% _____
If <1% damage, is salient present? Yes _____ No >10% _____
If yes, describe _____

WATER DAMAGE

Yes _____ No Description _____

PHYSICAL DAMAGE

Yes _____ No Description _____

AGE DETERIORATION

Yes _____ No Description _____

FORM 9 – Page 2

CDB BUILDING #: D0139

Homogeneous Area: MFA

DISTURBANCE FACTORS
 ACCESSIBLE TO OCCUPANTS
 MAINTENANCE PERSONNEL
 HEIGHT FROM FLOOR
 AREA ABOVE
 AREA ADJACENT
 OCCUPANCY (#)
 FREQUENCY OF USE (Hrs.)
 UTILIZATION OF AREA

Yes X No
 Yes X No
 N/A Fl.

Roof

Boiler Room, Shower Room, Bays

0 1-2 3-10 X 10+
 0 1-2 3-10 X 10+

Office/Restrooms

(distance in ft. to)

	<1	1-5	X	>5		VIBRATION	Yes	No	X
ELECTRICAL	<1	1-5	X	>5		MECHANICAL (MOTOR)	Yes	No	X
MECHANICAL	<1	1-5	X	>5		PLUMBING (KNOCKING)	Yes	No	X
PIPING	<1	1-5	X	>5		OTHER	Yes	No	X

OTHER

<1 1-5 >5

BARRIER
 SUSPENDED CEILING
 ENCAPSULATION
 ENCLOSURE
 OTHER

Yes No X
 Yes X No
 Yes No X
 Yes No X
 Yes No X

AIR MOVEMENT
 IF YES

Yes X No
 Low X Moderate Heavy

DISTANCE TO FRIABLE MATERIAL

EXTERIOR DOOR
 EXHAUST FAN
 GRAVITY VENT
 SUPPLY AIR
 RETURN AIR
 OTHER

Yes X No
 Yes X No
 Yes No X
 Yes No X
 Yes No X
 Yes No X

INSPECTOR'S ASSESSMENT

No Potential for Damage X Potential for Damage
 Potential for Significant Damage

EXPLANATION OF
 ASSESSMENT (REQUIRED)

The material is not damaged. Material should remain in an undamaged state presuming compliance with the O & M program.

DAMAGE PREVENTION
 MEASURE

N/A

COMMENTS

INSPECTOR'S SIGNATURE

[Handwritten Signature]

DATE 3.22.99

SAMPLE NUMBERS
 (Sampling Phase)

ACBM Yes No Assumed X

ILLINOIS DEPARTMENT OF TRANSPORTATION
STEVENSON EXPRESSWAY

CDB BUILDING NAME: MAINTENANCE
CDB BUILDING NUMBER: D0139

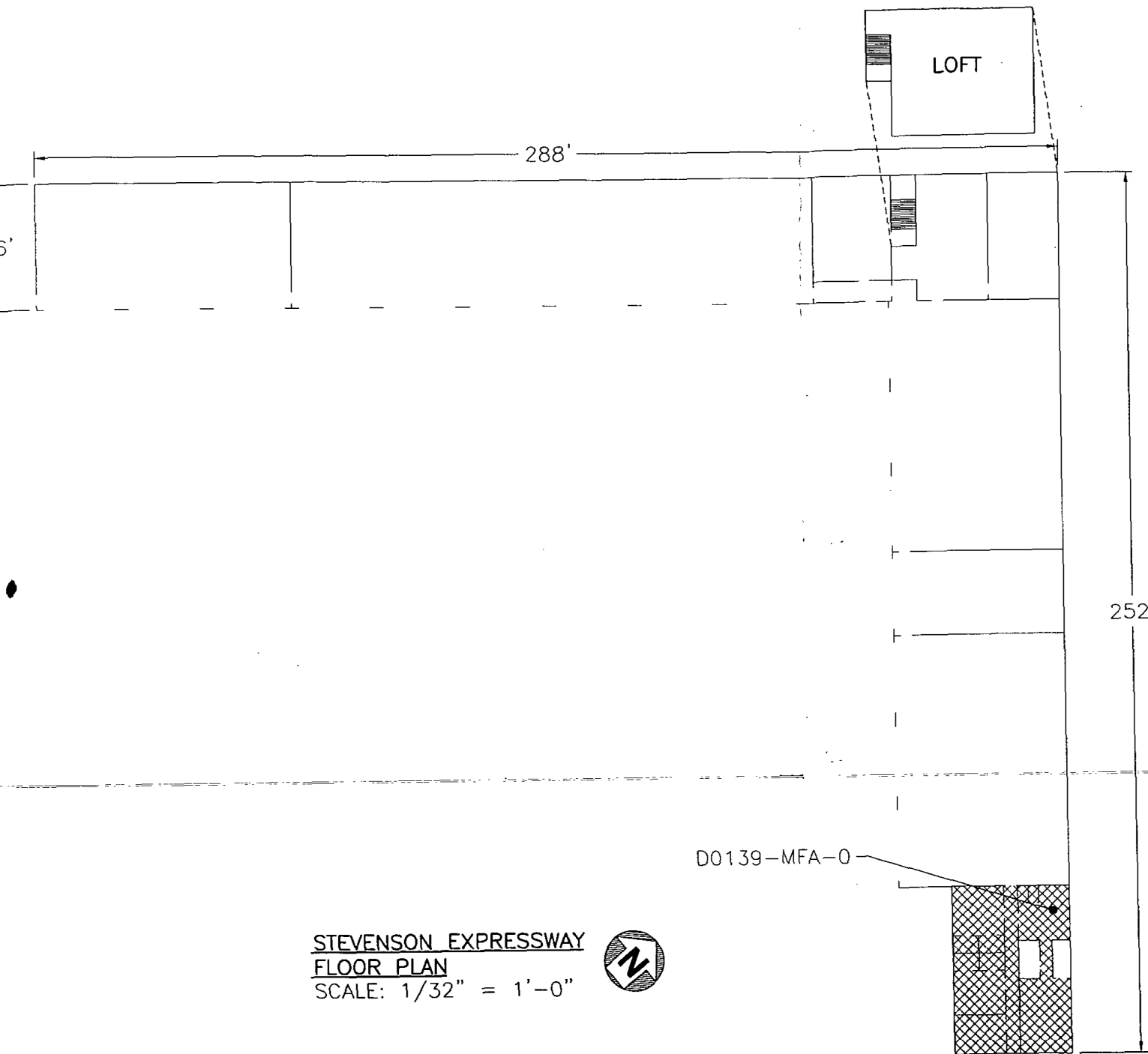

STEVENSON EXPRESSWAY
FLOOR PLAN
SCALE: 1/32" = 1'-0"



LEGEND

 HOMOGENEOUS AREA
12"X12" FLOOR TILE
WHITE WITH BLUE

GRAPHIC SCALE

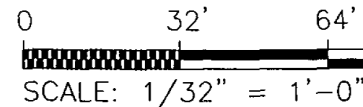

CAPITAL DEVELOPMENT BOARD
PROJECT #910-010-078

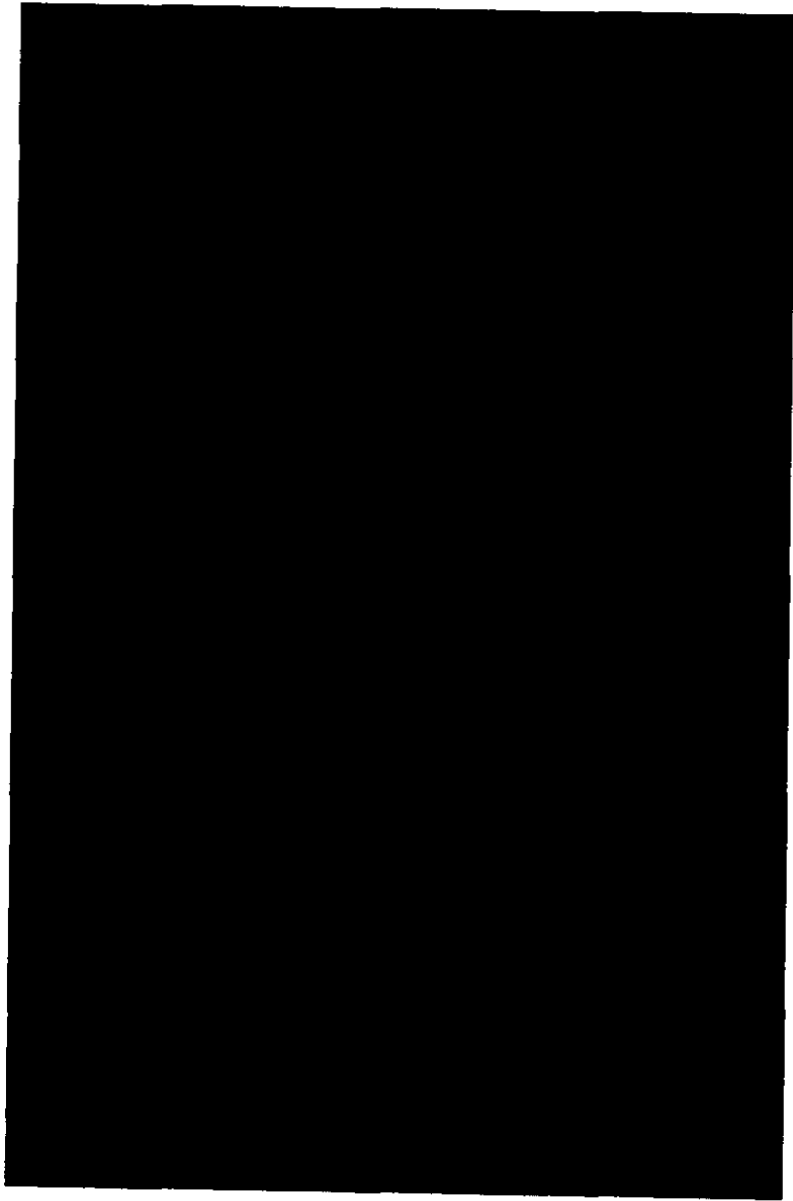

Illinois Department of Transportation
Stevenson Expressway - Maintenance Storage
D0139 - MFA - 0
12"x12" FLOOR TILE/MASTIC - WHITE WITH BLUE SPECS
December 18, 1998

FORM 13

A.1 BLDG NAME : Maintenance Storage CDB BLDG NO. D0139
HOMOGENEOUS AREA : MFA DESCRIPTION: 12"x12" Floor Tile/Mastic-White w/Blue Specs
QUANTITY: 900 sf

RESPONSE ACTION : 8

A.2.a. EXIST. COND. No Damage

POT. FOR DAMAGE : No Potential for Damage

A.2.b. FRIABLE : CONDITION : No Damage
DISTURBANCE : No Potential for Disturbance AIR FLOW : No
A.3.a (1) WHY : Based on normal use and occupancy there is no potential for damage presuming compliance with the O & M program.

A.3.a (2) Preventative Measures : Follow O & M Program

A.3.b O & M Procedures : Follow O & M Program

A.3.c. Health and Safety : Post warning signs and only allow trained personnel using protective equipment to enter areas.

A.4 Cost Estimate

A.4.a Unit Cost for Removal of ACM : \$5.55 x 900 sf = \$4,995.00

Type and Replacement of Non-ACM Material : Floor Tile and Mastic @ \$3.00 sf = \$2,700.00

Design Fee : \$200.00

Time Required for Removal (Days) : 1 day

APM/ASP Unit Cost (Daily Rate) : \$500.00

Cost Per Sample : 7 samples at \$20.00 = \$140.00

Indemnification Factor (%) : 5% (\$426.75)

Total Cost : \$ 8,961.75

A.4.b Cost of Recommended Response Action (O&M): \$100.00

A.4.c O&M Cost Estimate

Inspection and Administration by Designated Person 2 times per year

A.4.d Special Conditions

Relocation of occupants during construction (25% of total cost)

FORM 9

HOMOGENEOUS AREA INSPECTION REPORT

CDB Building #: D0139 Homogeneous Area MMA

INSPECTION DATE: 12-18-98 CDB PROJECT NO. 910-010-078

CONTROLLING AGENCY: Illinois Department of Transportation
 FACILITY: Stevenson Expressway

BUILDING NAME: Maintenance Storage

BUILDING ADDRESS: Joliet Road and First Avenue

AVE FIRM: Cape Environmental Management Inc

INSPECTOR: Daniel Gott IDPH LICENSE NO. 100-8428

LOCATION: McCook, Illinois

ROOMS: Bay 2

MATERIAL DESCRIPTION:
 (common designation – i.e. air cell)

TYPE OF SYSTEM:
 (i.e. hot water)

COLOR, TEXTURE, ETC.:

FRIABLE: Yes No Pipe Diameter: _____ Inches

TOTAL QUANTITY: _____ Sq. ft. _____ Lin Ft. _____ 2 _____ Ea.

QUANTITY IN: Occupied: _____ 2 _____ Restricted _____ Unoccupied _____

ROOM FINISHES:

CEILING: No Finish

WALLS: Concrete

FLOOR: Concrete

DAMAGE ASSESSMENT:

LOCALIZED OR DISTRIBUTED	No Damage	Damaged	Significant Damage
	<1% <input checked="" type="checkbox"/>	1-25% _____	>25% _____
	<1% <input checked="" type="checkbox"/>	1-10% _____	>10% _____
	If <1% damage, is salient present? If yes, describe		Yes _____ No <input checked="" type="checkbox"/>

WATER DAMAGE: Yes _____ No Description _____

PHYSICAL DAMAGE: Yes _____ No Description _____

AGE DETERIORATION: Yes _____ No Description _____

FORM 9 -- Page 2

CDB BUILDING #: D0139 Homogeneous Area: MMA

DISTURBANCE FACTORS
 ACCESSIBLE TO OCCUPANTS
 MAINTENANCE PERSONNEL
 HEIGHT FROM FLOOR
 AREA ABOVE
 AREA ADJACENT
 OCCUPANCY (#)
 FREQUENCY OF USE (Hrs.)
 UTILIZATION OF AREA

Yes No
 Yes No
 12 Ft.

Roof
 Bay, Tool Room
 0 1-2 3-10 10+
 0 1-2 3-10 10+
 Storage

SERVICEABLE COMPONENTS

(distance in ft. to) VIBRATION Yes No
 ELECTRICAL <1 1-5 >5 MECHANICAL (MOTOR) Yes No
 MECHANICAL <1 1-5 >5 PLUMBING (KNOCKING) Yes No
 PIPING <1 1-5 >5 OTHER Yes No

OTHER
 BARRIER
 SUSPENDED CEILING
 ENCAPSULATION
 ENCLOSURE
 OTHER
 AIR MOVEMENT
 IF YES

<1 1-5 >5
 Yes No
 Yes No
 Yes No
 Yes No
 Yes No
 Yes No
 Low Moderate Heavy

DISTANCE TO FRIABLE MATERIAL

EXTERIOR DOOR
 EXHAUST FAN
 GRAVITY VENT
 SUPPLY AIR
 RETURN AIR
 OTHER

Yes No
 Yes No
 Yes No
 Yes No
 Yes No
 Yes No

INSPECTOR'S ASSESSMENT

No Potential for Damage Potential for Damage
 Potential for Significant Damage

EXPLANATION OF ASSESSMENT (REQUIRED)

The material is not damaged. Material should remain in an undamaged state presuming compliance with the O & M program.

DAMAGE PREVENTION MEASURE

N/A

COMMENTS

INSPECTOR'S SIGNATURE

D. J. Dett

DATE 3-22-99

SAMPLE NUMBERS
 (Sampling Phase)

ACBM Yes No Assumed

ILLINOIS DEPARTMENT OF TRANSPORTATION
STEVENSON EXPRESSWAY

CDB BUILDING NAME: MAINTENANCE S
CDB BUILDING NUMBER: D0139

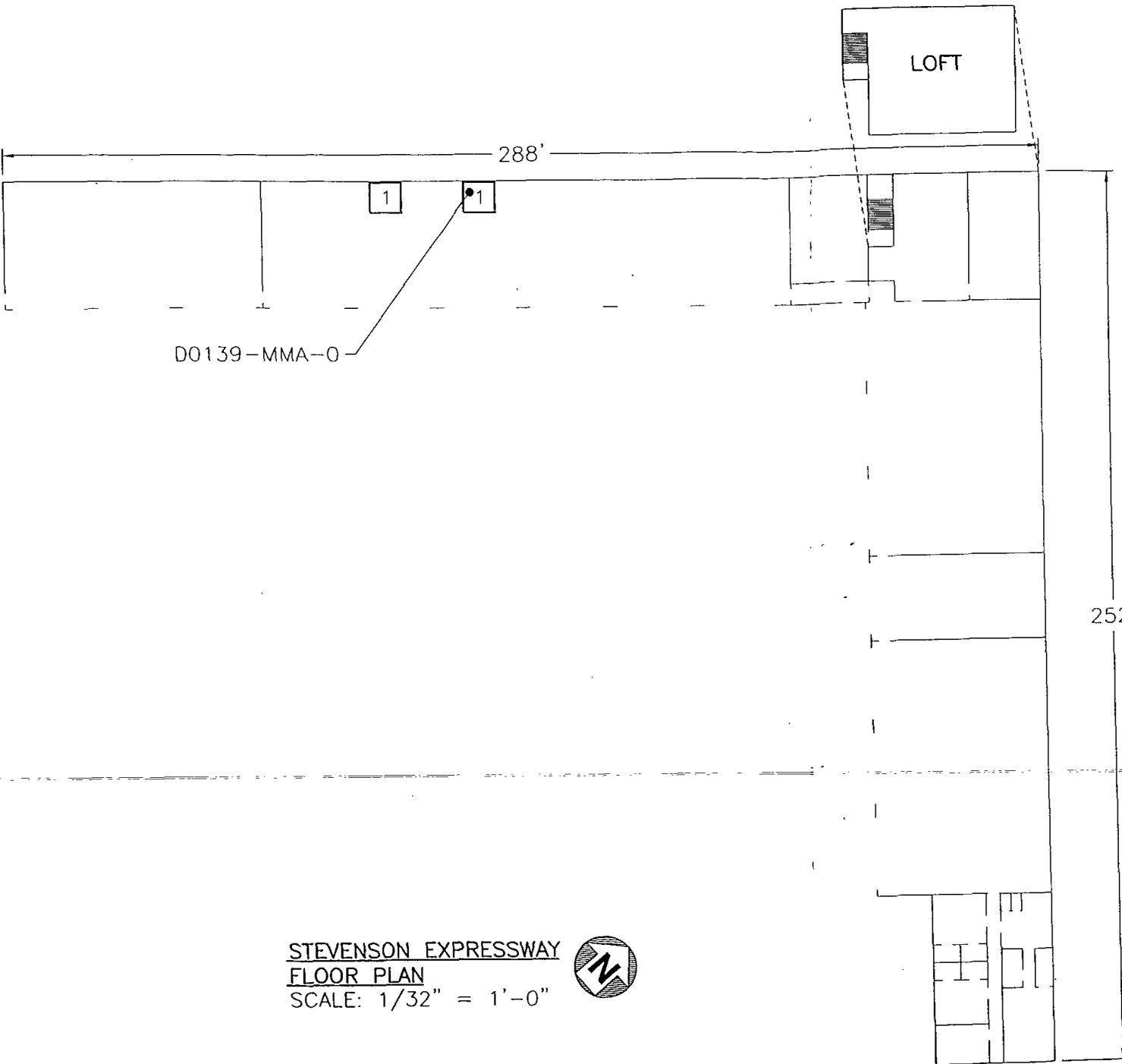

STEVENSON EXPRESSWAY
FLOOR PLAN
SCALE: 1/32" = 1'-0"



LEGEND

1 HOMOGENEOUS AREA:
VIBRATION DAMPERS
Response Action Pages 5-6

GRAPHIC SCALE

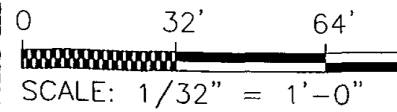

CAPITAL DEVELOPMENT BOARD
PROJECT #910-010-078

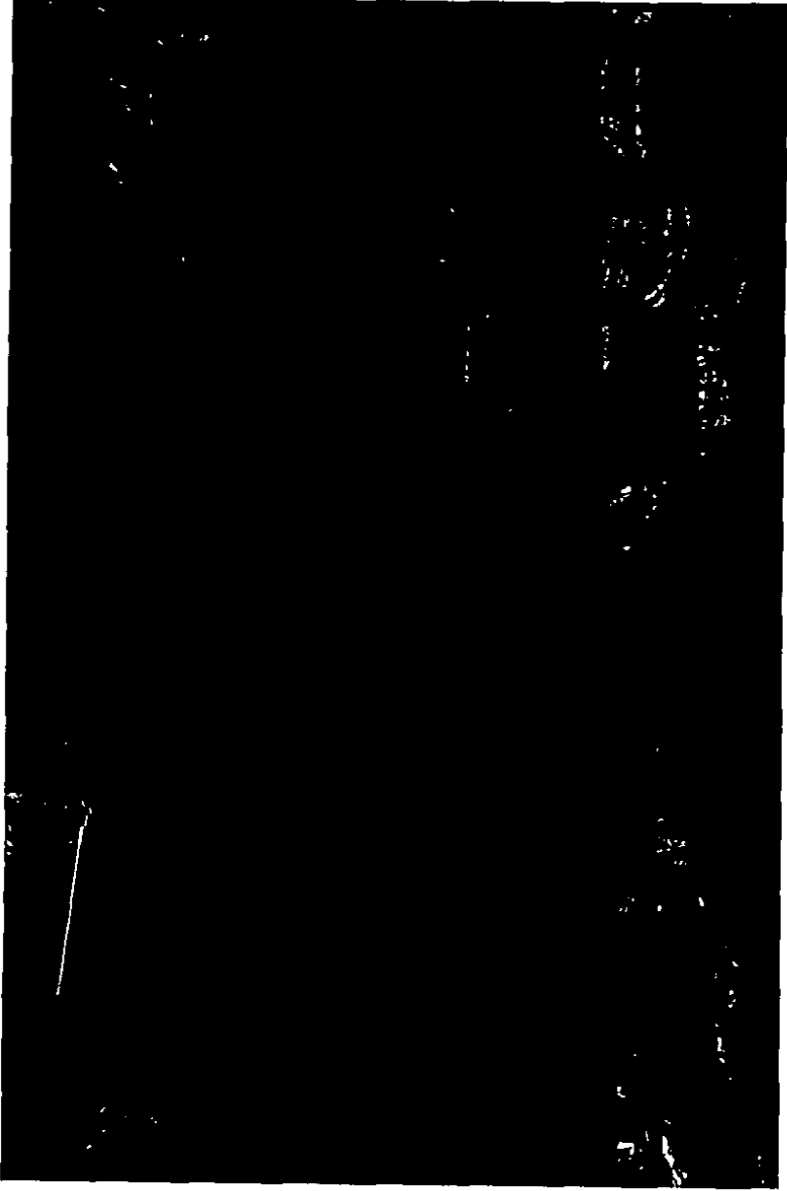

Illinois Department of Transportation
Stevenson Expressway – Maintenance Storage
D0139 – MMA – 0
VIBRATION DAMPERS
December 18, 1998

FORM 13

A.1 BLDG NAME : Maintenance Storage CDB BLDG NO. D0139
HOMOGENEOUS AREA : MMA DESCRIPTION: Vibration Dampers
QUANTITY: 2 each
RESPONSE ACTION : 8

A.2.a. EXIST. COND. No Damage

POT. FOR DAMAGE : No Potential for Damage

A.2.b. FRIABLE : CONDITION : No Damage
DISTURBANCE : No Potential for Disturbance AIR FLOW : No
A.3.a (1) WHY : Based on normal use and occupancy there is no potential for damage presuming compliance with the O & M program.

A.3.a (2) Preventative Measures : Follow O & M Program

A.3.b O & M Procedures : Follow O & M Program

A.3.c. Health and Safety : Post warning signs and only allow trained personnel using protective equipment to enter areas.

A.4 Cost Estimate

A.4.a Unit Cost for Removal of ACM : \$ 51.00 x 2 (each) = \$102.00

Type and Replacement of Non-ACM Material : Rubber @ \$15.00 each = \$30.00

Design Fee : \$200.00

Time Required for Removal (Days) : 1 day

APM/ASP Unit Cost (Daily Rate) : \$500.00

Cost Per Sample : 7 samples at \$20.00 = \$140.00

Indemnification Factor (%) : 5% (\$48.60)

Total Cost : \$ 1,020.60

A.4.b Cost of Recommended Response Action (O&M): \$100.00

A.4.c O&M Cost Estimate

Inspection and Administration by Designated Person 2 times per year

A.4.d Special Conditions

Relocation of occupants during construction (2.5% of total cost)

FORM 9

HOMOGENEOUS AREA INSPECTION REPORT

CDB Building #: D0139 Homogeneous Area MMB

INSPECTION DATE: 12-18-98 CDB PROJECT NO. 910-010-078

CONTROLLING AGENCY: Illinois Department of Transportation
FACILITY: Stevenson Expressway

BUILDING NAME: Maintenance Storage

BUILDING ADDRESS: Joliet Road and First Avenue

A/E FIRM: Cape Environmental Management Inc

INSPECTOR: Danial Gott IDPH LICENSE NO. 100-8428

LOCATION: McCook, Illinois

ROOMS: Bay 2

MATERIAL DESCRIPTION: Baseboard Mastic
(common designation - i.e. air cell)

TYPE OF SYSTEM: Wall
(i.e. hot water)

COLOR, TEXTURE, ETC.: Black

FRIABLE: Yes ___ No Pipe Diameter: ___ Inches

TOTAL QUANTITY: ___ Sq. ft. 550 Lin Ft. ___ Ea.

QUANTITY IN: Occupied: 550 Restricted ___ Unoccupied ___

ROOM FINISHES:

CEILING: 2x4 Ceiling Tile, Drywall

WALLS: Concrete

FLOOR: Floor Covering

DAMAGE ASSESSMENT:

LOCALIZED OR DISTRIBUTED
No Damage ___ Damaged ___ Significant Damage ___
<1% 1-25% ___ >25% ___
<1% 1-10% ___ >10% ___
If <1% damage, is salient present? Yes ___ No
if yes, describe

WATER DAMAGE: Yes ___ No Description ___

PHYSICAL DAMAGE: Yes ___ No Description ___

AGE DETERIORATION: Yes ___ No Description ___

FORM 9 - Page 2

CDB BUILDING #:

D0139

Homogeneous Area: MMB

DISTURBANCE FACTORS

ACCESSIBLE TO OCCUPANTS Yes No
 MAINTENANCE PERSONNEL Yes No
 HEIGHT FROM FLOOR 0 Ft.

AREA ABOVE

AREA ADJACENT Shower, Boiler Room, Bays

OCCUPANCY (#) 0 1-2 3-10 10+
 FREQUENCY OF USE (Hrs.) 0 1-2 3-10 10+

UTILIZATION OF AREA

Offices, Restrooms

SERVICEABLE COMPONENTS

(distance in ft. to)

ELECTRICAL	<1	1-5	X	>5	VIBRATION	Yes	No	X
MECHANICAL	<1	1-5	X	>5	MECHANICAL (MOTOR)	Yes	No	X
PIPING	<1	1-5	X	>5	PLUMBING (KNOCKING)	Yes	No	X
OTHER	<1	1-5	X	>5	OTHER	Yes	No	X

BARRIER

SUSPENDED CEILING Yes No
 ENCAPSULATION Yes No
 ENCLOSURE Yes No
 OTHER Yes No

AIR MOVEMENT IF YES

Yes No
 Low Moderate Heavy

DISTANCE TO FRIABLE MATERIAL

EXTERIOR DOOR Yes No
 EXHAUST FAN Yes No
 GRAVITY VENT Yes No
 SUPPLY AIR Yes No
 RETURN AIR Yes No
 OTHER Yes No

INSPECTOR'S ASSESSMENT

No Potential for Damage Potential for Damage
 Potential for Significant Damage

EXPLANATION OF

The material is not damaged. Material should remain in an undamaged state presuming compliance with

ASSESSMENT (REQUIRED)

the O & M program.

DAMAGE PREVENTION

N/A

MEASURE

COMMENTS

INSPECTOR'S SIGNATURE *[Signature]*

DATE 3.22.99

SAMPLE NUMBERS (Sampling Phase)

ACBM

Yes No

Assumed X

ILLINOIS DEPARTMENT OF TRANSPORTATION
STEVENS ON EXPRESSWAY

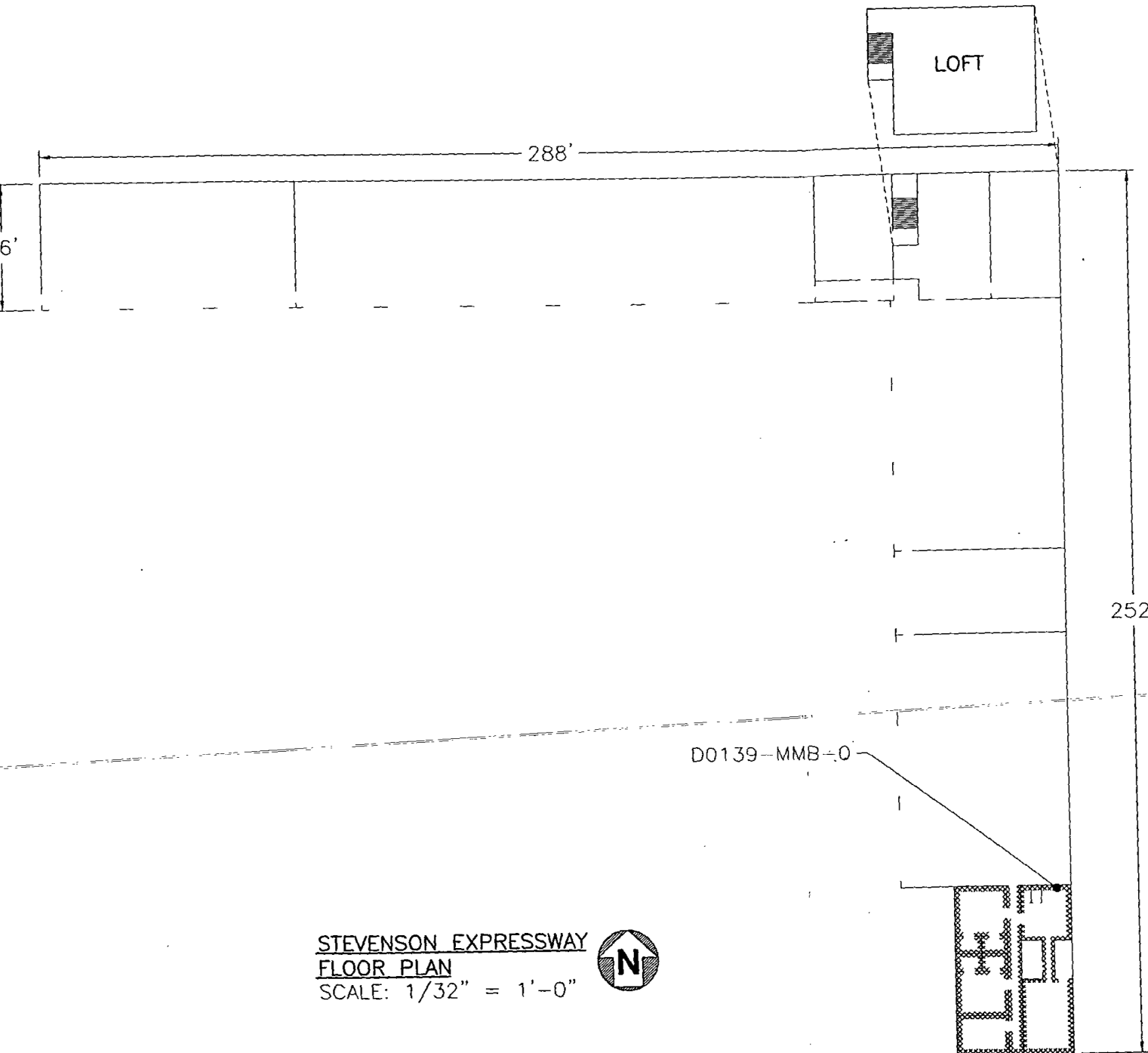

CDB BUILDING NAME: MAINTENANCE
CDB BUILDING NUMBER: D0139



STEVENS ON EXPRESSWAY
FLOOR PLAN
SCALE: 1/32" = 1'-0"



LEGEND

-  HOMOGENEOUS AREA
-  BASEBOARD MASTIC

GRAPHIC SCALE

0 32' 64'



SCALE: 1/32" = 1'-0"

CAPITAL DEVELOPMENT BOARD
PROJECT #910-010-078

“Not Available”

Illinois Department of Transportation
Stevenson Expressway – Maintenance Storage
D0139 – MMB – 0
BASEBOARD MASTIC
December 18, 1998

FORM 13

A.1 BLDG NAME : Maintenance Storage CDB BLDG NO. D0139
HOMOGENEOUS AREA : MMB DESCRIPTION: Baseboard Mastic
QUANTITY: 550 If
RESPONSE ACTION : 8

A.2.a. EXIST. COND. No Damage
POT. FOR DAMAGE : No Potential for Damage

A.2.b. FRIABLE : CONDITION : No Damage
DISTURBANCE : No Potential for Disturbance AIR FLOW : No
A.3.a (1) WHY : Based on normal use and occupancy there is no potential for damage presuming compliance with the O. & M program.

A.3.a (2) Preventative Measures : Follow O & M Program
A.3.b O & M Procedures : Follow O & M Program
A.3.c. Health and Safety : Post warning signs and only allow trained personnel using protective equipment to enter areas.

A.4 Cost Estimate
A.4.a Unit Cost for Removal of ACM : \$11.80 sf (by hand) x 550 If = \$6,490.00
Type and Replacement of Non-ACM Material : Baseboard glue @ \$1.50 If = \$825.00
Design Fee : \$200.00
Time Required for Removal (Days) : 1 day
APM/ASP Unit Cost (Daily Rate) : \$500.00
Cost Per Sample : 7 samples at \$20.00 = \$140.00

Indemnification Factor (%) : 5% (\$407.75)

Total Cost : \$8,562.75

A.4.b Cost of Recommended Response Action (O&M): \$100.00

A.4.c O&M Cost Estimate

Inspection and Administration by Designated Person 2 times per year

A.4.d Special Conditions

Relocation of occupants during construction (25% of total cost)

FORM 9

HOMOGENEOUS AREA INSPECTION REPORT

CDB Building #: D0139 Homogeneous Area MTA

INSPECTION DATE: 12-18-98 CDB PROJECT NO. 910-010-078

CONTROLLING AGENCY: Illinois Department of Transportation
FACILITY: Stevenson Expressway

BUILDING NAME: Maintenance Storage

BUILDING ADDRESS: Joliet Road and First Avenue

AVE FIRM: Cape Environmental Management Inc

INSPECTOR: Danial Gott IDPH LICENSE NO. 100-8428

LOCATION: McCook, Illinois

ROOMS: Loft, Tool Room

MATERIAL DESCRIPTION: (common designation - i.e. air cell)

TYPE OF SYSTEM: (i.e. hot water)

COLOR, TEXTURE, ETC.: Gray

FRIABLE: Yes No Pipe Diameter: _____ Inches

TOTAL QUANTITY: 36 Sq. ft. 36 Lin Ft. _____ Ea.

QUANTITY IN: Occupied: _____ Restricted: _____ Unoccupied: _____

ROOM FINISHES:

CEILING: No Finish

WALLS: Concrete

FLOOR: Concrete

DAMAGE ASSESSMENT:

LOCALIZED OR DISTRIBUTED: No Damage Damaged 1-25% _____ Significant Damage >25% _____
<1% 1-10% _____ >10% _____
If <1% damage, is salient present? Yes _____ No
If yes, describe _____

WATER DAMAGE: Yes _____ No Description _____

PHYSICAL DAMAGE: Yes _____ No Description _____

AGE DETERIORATION: Yes _____ No Description _____

FORM 9 – Page 2

CDB BUILDING #: D0139

Homogeneous Area: MTA

DISTURBANCE FACTORS
ACCESSIBLE TO OCCUPANTS
MAINTENANCE PERSONNEL
HEIGHT FROM FLOOR

Yes X No
Yes X No
8 Ft.

Roof, Loft

Break Room, Bay, Storage Room

0 1-2 3-10 X 10+
0 1-2 3-10 X 10+

FREQUENCY OF USE (Hrs.)

UTILIZATION OF AREA

SERVICEABLE COMPONENTS

(distance in ft. to)

VIBRATION

Yes No X

ELECTRICAL

<1 1-5 X >5

MECHANICAL (MOTOR)

Yes No X

MECHANICAL

<1 1-5 X >5

PLUMBING (KNOCKING)

Yes No X

PIPING

<1 1-5 X >5

OTHER

Yes No X

OTHER

<1 1-5 >5

BARRIER
SUSPENDED CEILING
ENCAPSULATION
ENCLOSURE
OTHER

Yes No X
Yes No X
Yes No X
Yes No X
Yes No X

AIR MOVEMENT
IF YES

Yes X No
Low X Moderate Heavy

DISTANCE TO FRIABLE MATERIAL

EXTERIOR DOOR
EXHAUST FAN
GRAVITY VENT
SUPPLY AIR
RETURN AIR
OTHER

Yes No X
Yes No X
Yes No X
Yes No X
Yes No X
Yes No X

INSPECTOR'S ASSESSMENT

No Potential for Damage X Potential for Damage
Potential for Significant Damage

EXPLANATION OF
ASSESSMENT (REQUIRED)

The material is not damaged. Material should remain in an undamaged state presuming compliance with the O & M program.

DAMAGE PREVENTION
MEASURE

N/A

COMMENTS

INSPECTOR'S SIGNATURE

[Signature]

DATE 3.22.99

SAMPLE NUMBERS
(Sampling Phase)

ACBM

Yes No Assumed X

ILLINOIS DEPARTMENT OF TRANSPORTATION
STEVENSON EXPRESSWAY

CDB BUILDING NAME: MAINTENANCE
CDB BUILDING NUMBER: D0139

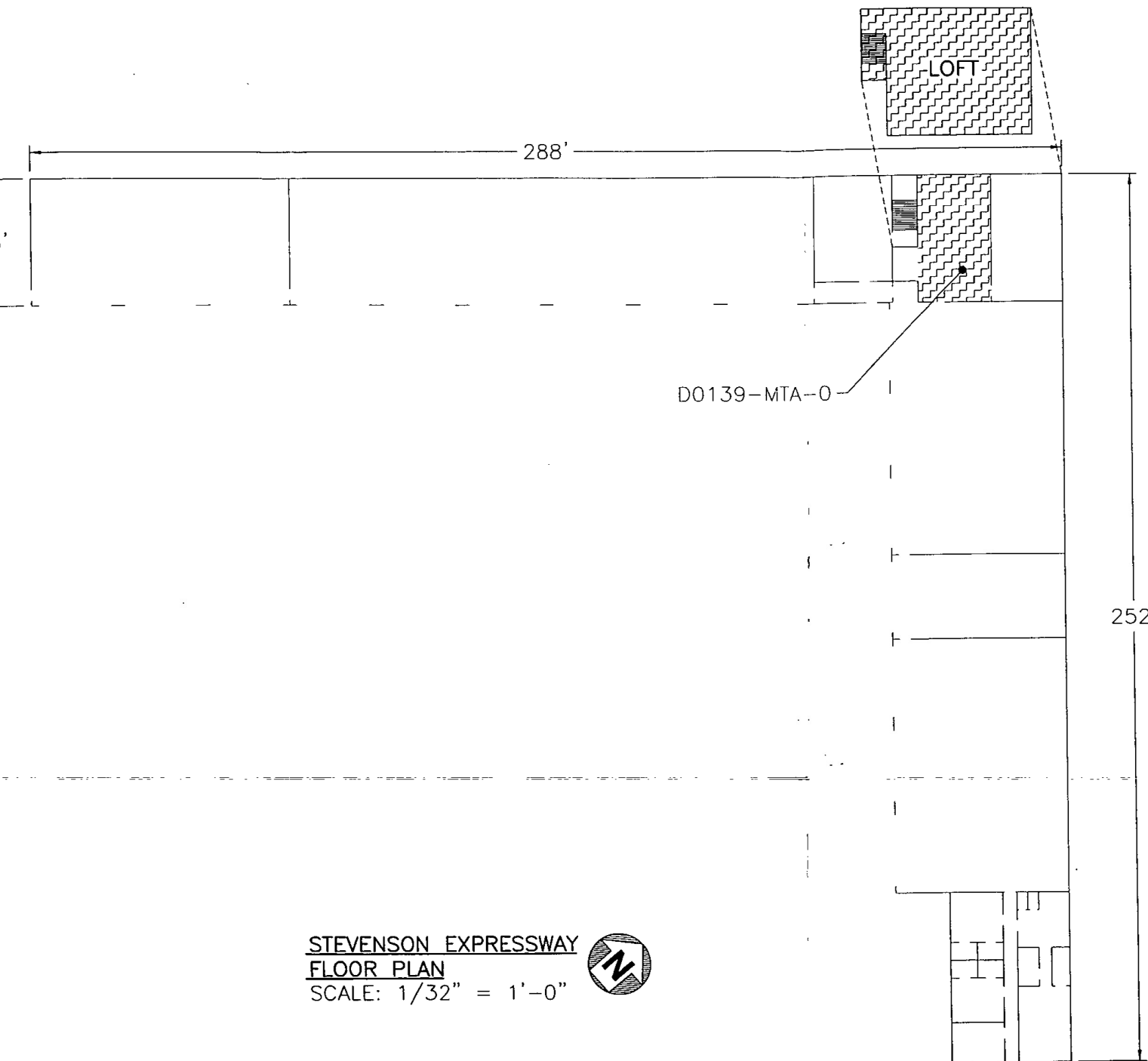

STEVENSON EXPRESSWAY
FLOOR PLAN
SCALE: 1/32" = 1'-0"



LEGEND

 HOMOGENEOUS AREA
TRANSITE CEILING F

GRAPHIC SCALE

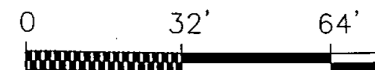

SCALE: 1/32" = 1'-0"

CAPITAL DEVELOPMENT BOARD
PROJECT #910-010-078

“Not Available”

Illinois Department of Transportation
Stevenson Expressway – Maintenance Storage
D0139 – MTA - 0
TRANSITE CEILING PANELS
December 18, 1998

FORM 13

A.1 BLDG NAME : Maintenance Storage CDB BLDG NO. D0139
HOMOGENEOUS AREA : MTA DESCRIPTION: Transite Ceiling Panels
QUANTITY: 32 sf

RESPONSE ACTION : 8

A.2.a. EXIST. COND. No Damage

POT. FOR DAMAGE : No Potential for Damage

A.2.b. FRIABLE : CONDITION : No Damage
DISTURBANCE : No Potential for Disturbance AIR FLOW : No
A.3.a (1) WHY : Based on normal use and occupancy there is no potential for damage presuming compliance with the O & M program.

A.3.a (2) Preventative Measures : Follow O & M Program

A.3.b O & M Procedures : Follow O & M Program

A.3.c. Health and Safety : Post warning signs and only allow trained personnel using protective equipment to enter areas.

A.4 Cost Estimate

A.4.a Unit Cost for Removal of ACM : $\$4.00 \times 32 \text{ sf} = \128.00

Type and Replacement of Non-ACM Material : Gypsum @ $\$2.50 \text{ sf} = \80.00

Design Fee : \$200.00

Time Required for Removal (Days) : 1 day

APM/ASP Unit Cost (Daily Rate) : \$500.00

Cost Per Sample : 7 samples at $\$20.00 = \140.00

Indemnification Factor (%) : 5% (\$52.40)

Total Cost : \$1,100.40

A.4.b Cost of Recommended Response Action (O&M): \$100.00

A.4.c O&M Cost Estimate

Inspection and Administration by Designated Person 2 times per year

A.4.d Special Conditions

Relocation of occupants during construction (25% of total cost)

FORM 9

HOMOGENEOUS AREA INSPECTION REPORT

CDB Building #: D0139 Homogeneous Area TPA

INSPECTION DATE: 12-18-98 CDB PROJECT NO. 910-010-078
 CONTROLLING AGENCY: Illinois Department of Transportation
 FACILITY: Stevenson Expressway

BUILDING NAME: Maintenance Storage

BUILDING ADDRESS: Joliet Road and First Avenue

A/E FIRM: Cape Environmental Management Inc

INSPECTOR: Danial Gott IDPH LICENSE NO. 100-8428

LOCATION: McCook, Illinois

ROOMS: Bays, Loft, Locker Room, Washroom,

MATERIAL DESCRIPTION: Pipe Insulation - Cardboard
 (common designation - i.e. air cell)

TYPE OF SYSTEM: Domestic Water System
 (i.e. hot water)

COLOR, TEXTURE, ETC.: Tan

FRIABLE: Yes No Pipe Diameter: 2 Inches

TOTAL QUANTITY: 750 Sq. ft. 750 Lin Ft. Ea.

QUANTITY IN: 750 Restricted Unoccupied

ROOM FINISHES:

CEILING: Wood, No Finish
 WALLS: Concrete
 FLOOR: Concrete

DAMAGE ASSESSMENT:

LOCALIZED OR DISTRIBUTED

No Damage	Damaged	Significant Damage
<1% <input checked="" type="checkbox"/>	1-25% <input type="checkbox"/>	>25% <input type="checkbox"/>
<1% <input checked="" type="checkbox"/>	1-10% <input type="checkbox"/>	>10% <input type="checkbox"/>

If <1% damage, is salient present? Yes No
 If yes, describe

WATER DAMAGE: Yes No Description

PHYSICAL DAMAGE: Yes No Description

AGE DETERIORATION: Yes No Description

FORM 9 - Page 2

CDB BUILDING #: D0139

Homogeneous Area: TPA

DISTURBANCE FACTORS ACCESSIBLE TO OCCUPANTS
 MAINTENANCE PERSONNEL
 HEIGHT FROM FLOOR

Yes No
 Yes No
 12 Ft.

AREA ABOVE

Roof

AREA ADJACENT

Bays, Offices

OCCUPANCY (#)

0 1-2 3-10 X 10+

FREQUENCY OF USE (Hrs.)

0 1-2 3-10 X 10+

UTILIZATION OF AREA

Storage, Restroom

SERVICEABLE COMPONENTS

(distance in ft. to)

VIBRATION

Yes No

ELECTRICAL

<1 1-5 X >5

MECHANICAL (MOTOR)

Yes No

MECHANICAL

<1 1-5 X >5

PLUMBING (KNOCKING)

Yes No

PIPING

<1 1-5 X >5

OTHER

Yes No

OTHER

<1 1-5 >5

BARRIER
 SUSPENDED CEILING
 ENCAPSULATION
 ENCLOSURE
 OTHER

Yes No
 Yes No
 Yes No
 Yes No
 Yes No

AIR MOVEMENT IF YES

Yes No
 Low Moderate Heavy

DISTANCE TO FRIABLE MATERIAL

EXTERIOR DOOR
 EXHAUST FAN
 GRAVITY VENT
 SUPPLY AIR
 RETURN AIR
 OTHER

Yes No
 Yes No
 Yes No
 Yes No
 Yes No
 Yes No

INSPECTOR'S ASSESSMENT

No Potential for Damage Potential for Damage
 Potential for Significant Damage

EXPLANATION OF ASSESSMENT (REQUIRED)

The material is not damaged. Material should remain in an undamaged state presuming compliance with the O & M program.

DAMAGE PREVENTION

N/A

MEASURE

COMMENTS

INSPECTOR'S SIGNATURE

[Signature]

DATE 3.22.99

SAMPLE NUMBERS (Sampling Phase)

TPA-1, TPA-2, TPA-3

ACBM

Yes No

Assumed

ILLINOIS DEPARTMENT OF TRANSPORTATION
STEVENSON EXPRESSWAY

CDB BUILDING NAME: MAINTENANCE
CDB BUILDING NUMBER: D0139

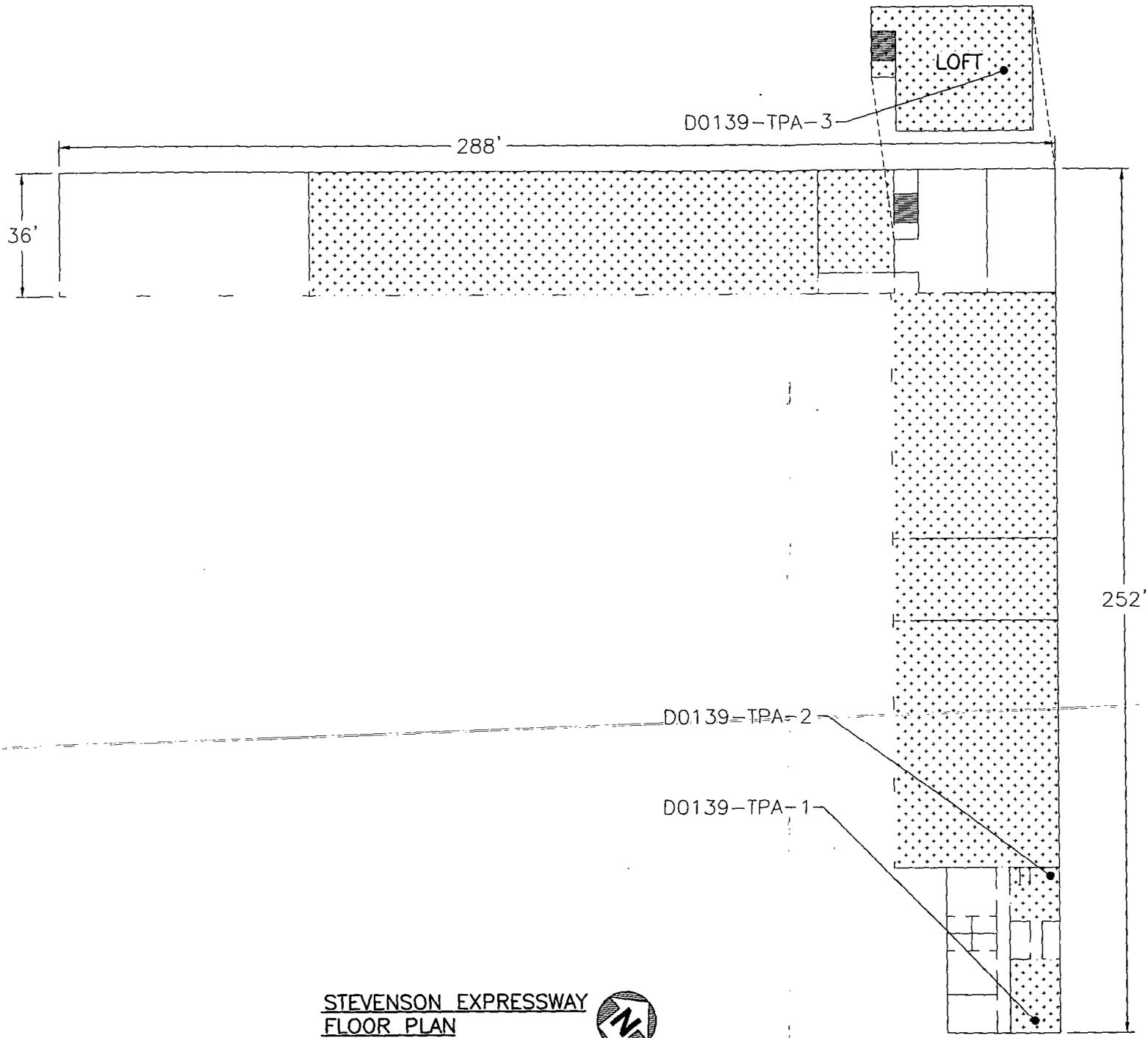

LEGEND
[Stippled Box] HOMOGENEOUS AREA:
[Stippled Box] CARDBOARD PIPE INSULATION
[Stippled Box] DOMESTIC WATER SYSTEM

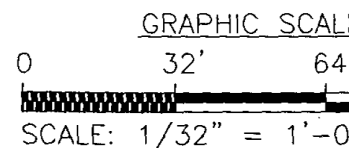

STEVENSON EXPRESSWAY
FLOOR PLAN
SCALE: 1/32" = 1'-0" 

CAPITAL DEVELOPMENT BOARD
PROJECT #910-010-078

FORM 11

BULK SAMPLE LABORATORY ANALYSIS REPORT

1. FACILITY: IDOT-Stevenson Expressway 2. CDB BUILDING #: D0139
 3. BUILDING: Maintenance Storage 4. CLIENT (A/E): CAPE ENVIRONMENTAL
 ADDRESS: Joliet Road & First Avenue 6. PROJECT #: 910-010-078
 7. HOMOGENEOUS AREA (ONLY 1 PER FORM) TPA

(A/E COMPLETE ITEMS 1-10 & PROVIDE TO LABORATORY.)

8. Location	Maintenance Storage	Maintenance Storage	Maintenance Storage
9. Date Collected	12/17/98	12/17/98	12/17/98
10. Sample No.	TPA-01	TPA-02	TPA-03
11. Date Received	1/29/99	1/29/99	1/29/99
12. Lab Sample No.	201665-04	201665-05	201665-06
13. Color?	GRAY	GRAY	GRAY
14. Fibrous?	YES	YES	YES
15. Layers?	1	1	1
16. Contains Asbestos?	NO	NO	NO
17. TYPE AND % ASBESTOS			
Chrysotile			
Amosite			
Crocidolite			
Other			
Total Asbestos %			
18. OTHER MATERIAL %			
Fibrous Glass			
Cellulose	80-85%	80-85%	80-85%
Synthetic Fibers			
Gypsum			
Calcite			
Quartz			
Perlite			
Vermiculite			
Others (BINDER)	15-20%	15-20%	15-20%
19. Date Analyzed	2/2/99	2/2/99	2/2/99
20. Analyzed By	Albio Marquez	Albio Marquez	Albio Marquez

All samples analyzed by polarized light microscopy with dispersion staining.

21. Report Approved By: [Signature] 22. Date: 2/2/1999

Laboratory Name: STAFF ANALYSIS

“Not Available”

Illinois Department of Transportation
Stevenson Expressway – Maintenance Storage
D0139 – TPA – 1
CARDBOARD PIPE FITTING INSULATION ON
DOMESTIC WATER SYSTEM
December 18, 1998

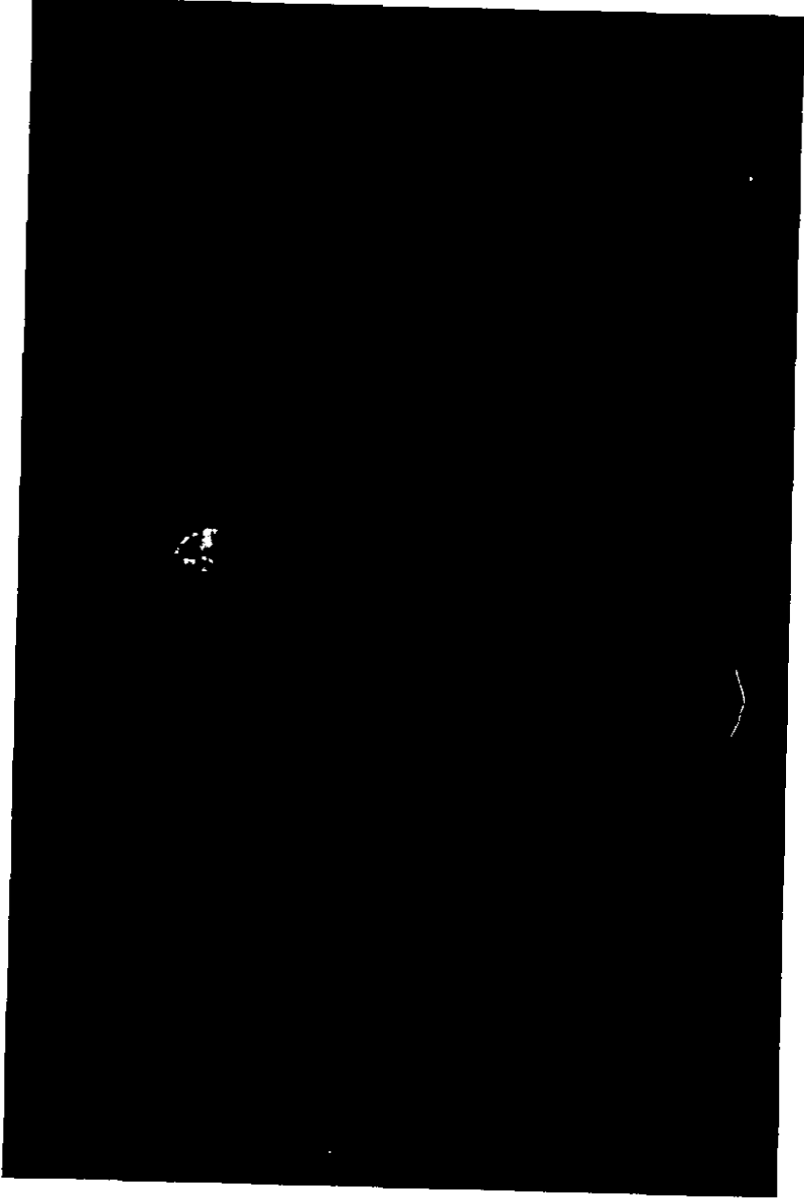

Illinois Department of Transportation
Stevenson Expressway - Maintenance Storage
D0139 - TPA - 2
CARDBOARD PIPE FITTING INSULATION ON
DOMESTIC WATER SYSTEM
December 18, 1998

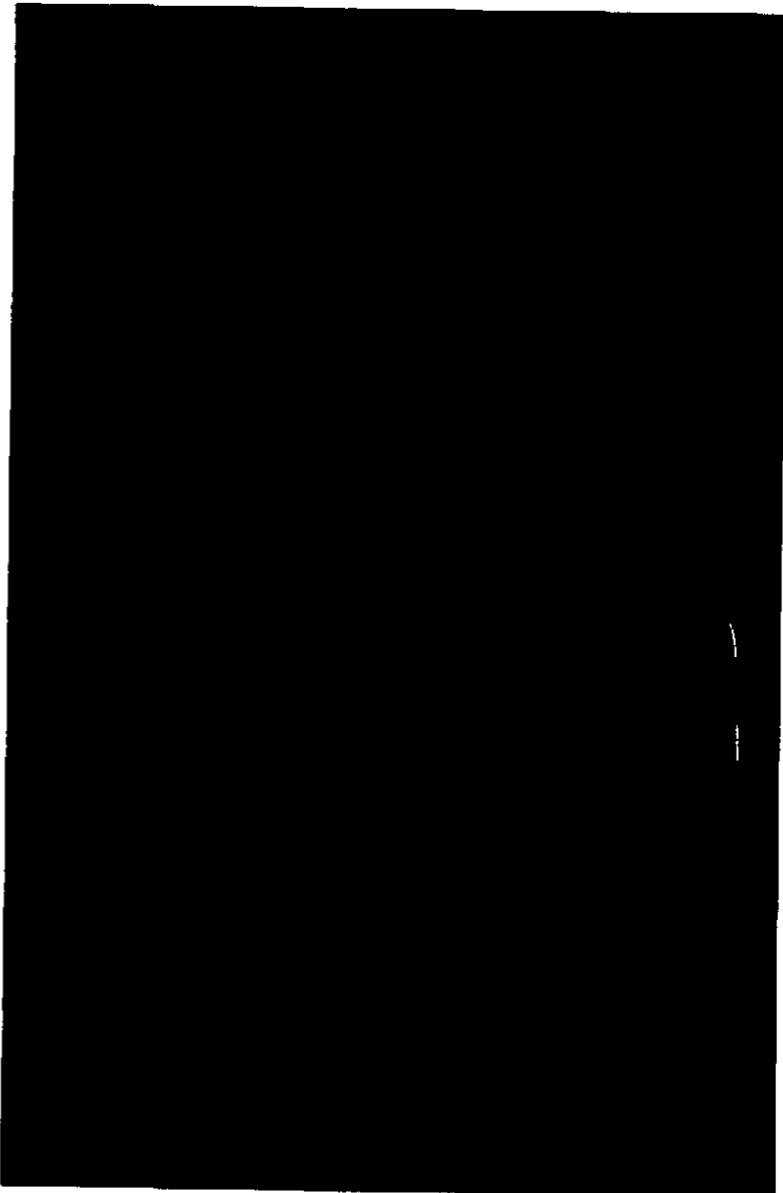

Illinois Department of Transportation
Stevenson Expressway - Maintenance Storage
D0139 - TPA - 3
CARDBOARD PIPE FITTING INSULATION ON
DOMESTIC WATER SYSTEM
December 18, 1998

FORM 9

HOMOGENEOUS AREA INSPECTION REPORT

CDB Building #: D0139 Homogeneous Area MCA

INSPECTION DATE: 12-18-98 CDB PROJECT NO. 910-010-078

CONTROLLING AGENCY: Illinois Department of Transportation
FACILITY: Stevenson Expressway

BUILDING NAME: Maintenance Storage

BUILDING ADDRESS: Joliet Road and First Avenue

A/E FIRM: Cape Environmental Management Inc

INSPECTOR: Danial Gott IDPH LICENSE NO. 100-8428

LOCATION: McCook, Illinois

ROOMS: Offices

MATERIAL DESCRIPTION: 2' x 4' Ceiling Tile - Lay-in
(common designation - i.e. air cell)

TYPE OF SYSTEM: Ceiling
(i.e. hot water)

COLOR, TEXTURE, ETC.: White with Fissured Pattern

FRIABLE: Yes No Pipe Diameter: _____ Inches

TOTAL QUANTITY: _____ Sq. ft. 500 Lin Ft. _____ Ea.

QUANTITY IN: Occupied: 500 Restricted _____ Unoccupied _____

ROOM FINISHES:

CEILING: 2x4 Ceiling Tile

WALLS: Concrete

FLOOR: Floor Covering

DAMAGE ASSESSMENT:

LOCALIZED OR DISTRIBUTED
No Damage Damaged Significant Damage
<1% 1-25% _____ >25% _____
<1% 1-10% _____ >10% _____
If <1% damage, is salient present? Yes _____ No
If yes, describe _____

WATER DAMAGE: Yes _____ No Description _____

PHYSICAL DAMAGE: Yes _____ No Description _____

AGE DETERIORATION: Yes _____ No Description _____

FORM 9 -- Page 2

CDB BUILDING #:

D0139

Homogeneous Area: MCA

DISTURBANCE FACTORS

ACCESSIBLE TO OCCUPANTS Yes No
 MAINTENANCE PERSONNEL Yes No
 HEIGHT FROM FLOOR 8 Ft.
 AREA ABOVE

AREA ADJACENT

Restroom, Closets, Halfway
 0 1-2 3-10 10+
 0 1-2 3-10 10+

FREQUENCY OF USE (Hrs.)

UTILIZATION OF AREA Office

SERVICEABLE COMPONENTS

(distance in ft. to)			VIBRATION	Yes	No	X
ELECTRICAL	<1	1-5	X >5	Yes	No	X
MECHANICAL	<1	1-5	X >5	Yes	No	X
PIPING	<1	1-5	X >5	Yes	No	X

OTHER

<1 1-5 >5

BARRIER
 SUSPENDED CEILING Yes No
 ENCAPSULATION Yes No
 ENCLOSURE Yes No
 OTHER Yes No

AIR MOVEMENT IF YES

Yes No
 Low Moderate Heavy

DISTANCE TO FRIABLE MATERIAL

EXTERIOR DOOR Yes No
 EXHAUST FAN Yes No
 GRAVITY VENT Yes No
 SUPPLY AIR Yes No
 RETURN AIR Yes No
 OTHER Yes No

INSPECTOR'S ASSESSMENT

No Potential for Damage Potential for Damage
 Potential for Significant Damage

EXPLANATION OF

ASSESSMENT (REQUIRED) The material is not damaged. Material should remain in an undamaged state presuming compliance with the O & M program.

DAMAGE PREVENTION

N/A

MEASURE

COMMENTS

INSPECTOR'S SIGNATURE *Pip J. H.*

DATE 3.22.99

SAMPLE NUMBERS (Sampling Phase)

MCA-1, MCA-2, MCA-3

ACBM

Yes No Assumed

ILLINOIS DEPARTMENT OF TRANSPORTATION
STEVENSON EXPRESSWAY

CDB BUILDING NAME: MAINTENANCE
CDB BUILDING NUMBER: D0139

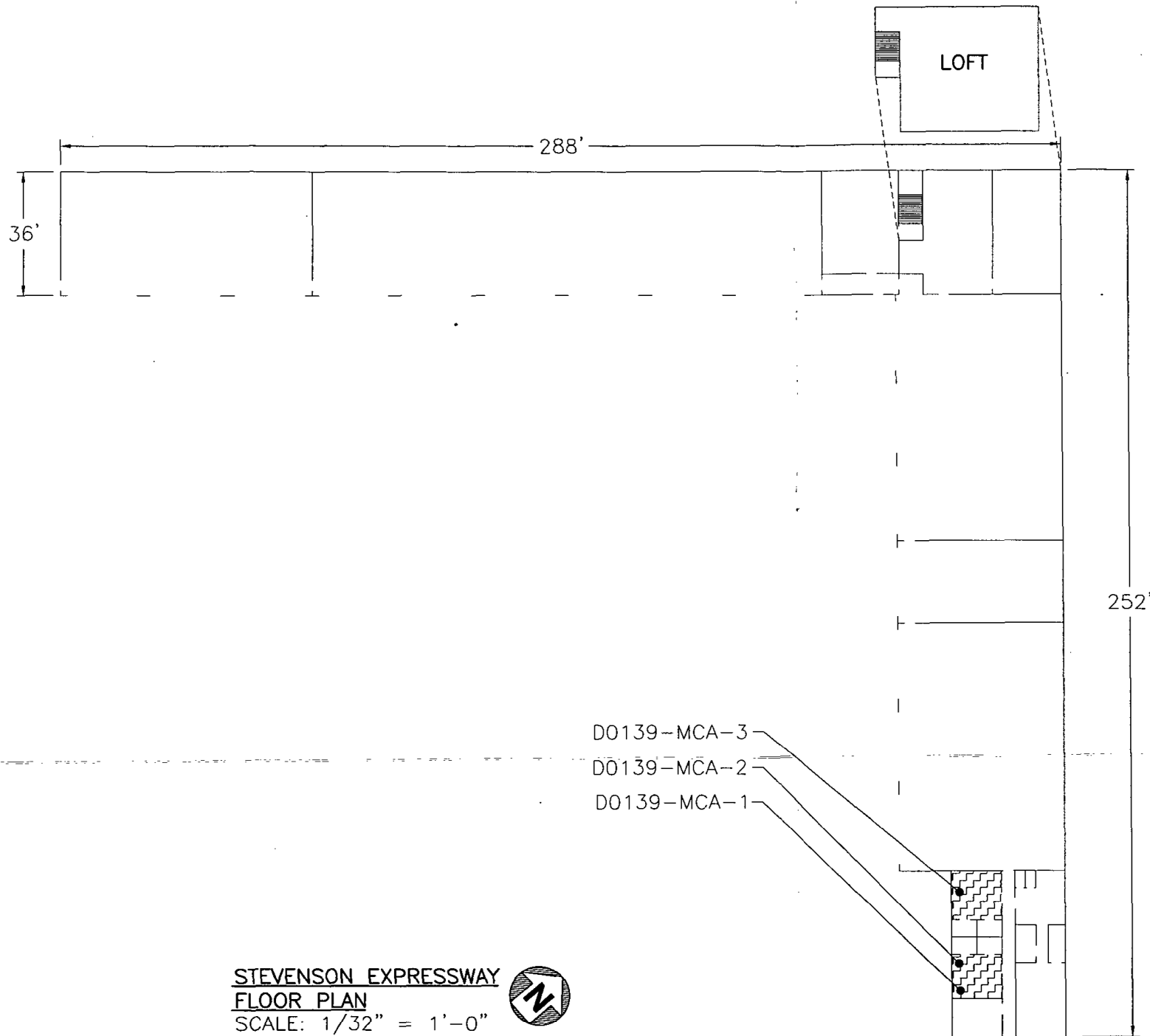

STEVENSON EXPRESSWAY
FLOOR PLAN
SCALE: 1/32" = 1'-0"



LEGEND

 HOMOGENEOUS AP
2'X4' CEILING TILE
FISSURED PATTERN

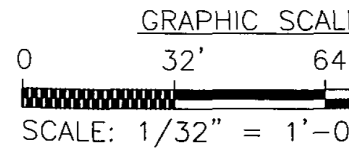

CAPITAL DEVELOPMENT BO
PROJECT #910-010-078

FORM 11

BULK SAMPLE LABORATORY ANALYSIS REPORT

1. FACILITY: IDOT-Stevenson Expressway 2. CDB BUILDING #: D0139
 3. BUILDING: Maintenance Storage 4. CLIENT (A/E): CAPE ENVIRONMENTAL
 ADDRESS: Joliet Road & First Avenue 6. PROJECT #: 910-010-078

7. HOMOGENEOUS AREA (ONLY 1 PER FORM) MCA
 (A/E COMPLETE ITEMS 1-10 & PROVIDE TO LABORATORY.)

8. Location	Maintenance Storage	Maintenance Storage	Maintenance Storage
9. Date Collected	12/17/98	12/17/98	12/17/98
10. Sample No.	MCA-01	MCA-02	MCA-03
11. Date Received	1/29/99	1/29/99	1/29/99
12. Lab Sample No.	201665-07	201665-08	201665-09
13. Color?	GRAY/WHITE	GRAY/WHITE	GRAY/WHITE
14. Fibrous?	YES	YES	YES
15. Layers?	2	2	2
16. Contains Asbestos?	NO	NO	NO
17. TYPE AND % ASBESTOS			
Chrysotile			
Amosite			
Crocidolite			
Other			
Total Asbestos %			
18. OTHER MATERIAL %			
Fibrous Glass	30-35%	30-35%	30-35%
Cellulose	30-35%	30-35%	30-35%
Synthetic Fibers			
Gypsum			
Calcite			
Quartz			
Perlite			
Vermiculite			
Others (BINDER)	30-35%	30-35%	30-35%
19. Date Analyzed	2/2/99	2/2/99	2/2/99
20. Analyzed By	Albio Marquez	Albio Marquez	Albio Marquez

All samples analyzed by polarized light microscopy with dispersion staining.

21. Report Approved By: *Albio Marquez* 22. Date: 2/2/1999

Laboratory Name: STAT ANALYSIS / *Albio Marquez*
(Signature)

“Not Available”

Illinois Department of Transportation
Stevenson Expressway – Maintenance Storage
D0139 – MCA – 1
2’x4’ CEILING TILE- LAY-IN-FISSURED PATTERN
December 18, 1998

“Not Available”

Illinois Department of Transportation
Stevenson Expressway – Maintenance Storage
D0139 – MCA – 2
2’x4’ CEILING TILE- LAY-IN-FISSURED PATTERN
December 18, 1998

“Not Available”

Illinois Department of Transportation
Stevenson Expressway - Maintenance Storage
D0139 - MCA - 3
2'x4' CEILING TILE- LAY-IN-FISSURED PATTERN
December 18, 1998

FORM 14 COST SUMMARY

BUILDING NAME: Maintenance Storage

C.D.B. BUILDING NUMBER: D0139

HOMOGENEOUS AREA	MATERIAL DESCRIPTION	NO.	RESPONSE ACTION		COST OF RESPONSE EXCL. O & M	COST OF ANNUAL O&M	COST OF REMOVAL
			DESCRIPTION				
TJA	Cementitious Pipe Fitting Insulation on Domestic System	8	O & M Program		\$100.00		\$21,091.35
MFA	12" x 12" Floor Tile/Mastic - White with Blue Specs	8	O & M Program		\$100.00		\$8,961.75
MMA	Vibration Dampers	8	O & M Program		\$100.00		\$1,020.60
MMB	Baseboard Mastic	8	O & M Program		\$100.00		\$8,562.75
MTA	Transite Ceiling Panels	8	O & M Program		\$100.00		\$1,100.40
BUILDING TOTALS					\$500.00		\$40,736.85

CHAIN OF CUSTODY RECORD FOR ASBESTOS BULK SAMPLES

1. CDB Bldg. No.: DO139

2. Batch #: _____

3. Facility Name: FDOT - SEVENSON EXPRESSWAY

4. CDB Project #: 910-C10-078

5. Building Name: Maintenance Storage

6. Date Samples Collected: 12-17-98

7. Name of Inspector: Nickolas Briglio

8. Project Name: FAOT

9. License #: LD-3516

10. Sample Numbers: IJA-1, IJA-2, IJA-3

IJA-1, IJA-2, IJA-3; MCA-1, MCA-2, MCA-3

11. Total # Samples: 9

12. Sample numbers relinquished: IJA-1, IJA-2, IJA-3; IJA-1, IJA-2, IJA-3; MCA-1, MCA-2, MCA-3

Relinquished by: Nickolas Briglio

Signature: Nickolas Briglio

Method of Transmission: Hand Delivery

Date and Time: 12/19 10:00 AM

Representing: Cape Environmental

Sample numbers received: IJA-1, IJA-2, IJA-3; IJA-1, IJA-2, IJA-3; MCA-1, MCA-2, MCA-3

Received by: Kristine Van Dongen

Signature: Kristine Van Dongen

Condition of Sample Upon Receipt: Good

Date and Time: 12/29/99 10:00 AM

Reason for Obtaining Sample: Delivery to Lab

Representing: Cape Environmental

13. Sample numbers relinquished: As listed above #7-9

Relinquished by: Kristine Van Dongen

Signature: Kristine Van Dongen

Method of Transmission: Expressway

Date and Time: 12/29/99 4pm

Representing: CAPE ENVIRONMENTAL

Sample numbers received: 9

Received by: Albio Marguez

Signature: Albio Marguez

Condition of Sample Upon Receipt: Good

Date and Time: 1/25/00 3PM

Reason for Obtaining Sample: ANALYSIS

Representing: STAT ANALYSIS

14. Sample numbers relinquished: 9

Relinquished by: Albio Marguez

Signature: Albio Marguez

Method of Transmission: Good

Date and Time: 1/25/00 3PM

Representing: STAT ANALYSIS

Sample numbers received: 9 (as listed)

Received by: Kristine Van Dongen

Signature: Kristine Van Dongen

Condition of Sample Upon Receipt: Good

Date and Time: 2/5/99 12 noon

Reason for Obtaining Sample: Receipt for Report

Representing: CAPE ENVIRONMENTAL

18. Sample numbers relinquished: As listed above (9)
 Relinquished by: Kristine Van Dongen Representing: CAPE Environmental
 Signature: Kristine Van Dongen
 Method of Transmission: Airborne Express
 Date and Time: 5-28-99 4pm

Sample numbers received: SAME AS #10 ABOVE 9 SAMPLES
 Received by: S. GABLIWICK Representing: CDB
 Signature: [Signature]
 Condition of Sample Upon Receipt: GOOD
 Date and Time: 6/1/99 3PM
 Reason for Obtaining Sample: STORE

19. Sample numbers relinquished: _____
 Relinquished by: _____ Representing: _____
 Signature: _____
 Method of Transmission: _____
 Date and Time: _____

Sample numbers received: _____
 Received by: _____ Representing: _____
 Signature: _____
 Condition of Sample Upon Receipt: _____
 Date and Time: _____
 Reason for Obtaining Sample: _____

20. Sample numbers relinquished: _____
 Relinquished by: _____ Representing: _____
 Signature: _____
 Method of Transmission: _____
 Date and Time: _____

Sample numbers received: _____
 Received by: _____ Representing: _____
 Signature: _____
 Condition of Sample Upon Receipt: _____
 Date and Time: _____
 Reason for Obtaining Sample: _____

Chain of Custody is completed with delivery of samples to a CDB Sample Custodian. Project Manager shall make arrangements for delivery.

Moraine Valley Community College
Environmental Institute
AHERA Accreditation

This certificate is awarded to

KURT GATES

In recognition of attending the required eight hour refresher course and successfully passing the written examination, attaining a score of 70 percent or greater, for accreditation as a:

Project Designer

Course Date	Test Date	Expiration Date	Social Security #	Accreditation #
November 3, 1998	November 3, 1998	November 2, 1999	159-58-8735	1198PDR005

This course is fully approved by the U.S. EPA only for purposes of accreditation under Title II of the Toxic Substances Control Act, 40 CFR part 763. This course is further approved by the Illinois Department of Public Health and the Indiana Department of Environmental Management



Moraine Valley
Community College

10900 South 88th Avenue
Palos Hills, IL 60465-0937
708-974-6416
CM Points Awarded: 1.0

Instructional Coordinator

Mary Ann Cook

Mary Ann Cook

The
American Board of Industrial Hygiene[®]
ABIH[®]

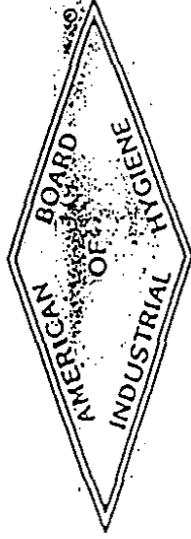

organized to improve the practice of Industrial Hygiene
proclaims that

Murt J. Gates

having met all requirements through
education, experience, and examination,
is hereby certified in the

COMPREHENSIVE PRACTICE
of
INDUSTRIAL HYGIENE

and has the right to use the designations

CERTIFIED INDUSTRIAL HYGIENIST



CIH
July 6, 1993
date
Chairman ABIH

Secretary ABIH
5935
certificate
number

The University of Illinois at Chicago
School of Public Health

A7342

MIDWEST ASBESTOS INFORMATION CENTER



Certifies that

NICHOLAS S. BRIGLIO

321-66-4721

Has Attended the Continuing Education Course

BUILDING INSPECTION

(Accredited under AHERA by EPA)

which has been fully approved and accredited by the Illinois
Department of Public Health

and Successfully Passed the Competency Exam

With a minimum score of at least 70 %

DATE OF EXAMINATION : 11/28/90

Date of Issuance 11/28/90

Date of Expiration 11/28/91

COURSE DATE: 11/26/90 TO 11/28/90

Director
Continuing Education
Audrey K. Gordon

Dean
School of Public Health
Jack & Nancy MD



Moraine Valley Community College
 Environmental Institute
 AHERA Accreditation

NICKOLAS S. BRIGLIO

In recognition of attending the required four-hour refresher course and successfully passing the written examination, attaining a score of 70 percent or greater, for accreditation as a:

Building Inspector

Course Dates	Test Date	Expiration Date	Social Security #	Accreditation #
April 22, 1997	April 22, 1997	April 21 1998	321-66-4721	497BR006

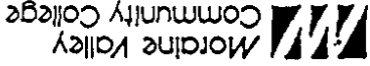

Moraine Valley Community College
 10900 South 88th Avenue
 Polos Hills, IL 60465-0937
 (708) 974-5735

Bill Wendt
 Director

Bill Wendt

This course is fully approved by the U.S. EPA only for purposes of accreditation under Title II of the Toxic Substances Control Act, 40 CFR Part 763. This course is further approved by the Illinois Department of Public Health and the Indiana Department of Environmental Management.

Moraine Valley Community College
 Environmental Institute
 AHERA Accreditation
 This certificate is awarded to
NICKOLAS S. BRIGLIO

In recognition of attending the required four-hour refresher course and successfully passing the written examination, attaining a score of 70 percent or greater, for accreditation as a:

Management Planner

Course Date	Test Date	Expiration Date	Social Security #	Accreditation #
May 6, 1998	May 6, 1998	May 5, 1999	321-66-4721	598MR003

This course is fully approved by the U.S. EPA only for purposes of accreditation under Title II of the Toxic Substances Control Act 40 CFR part 763. This course is further approved by the Illinois Department of Public Health and the Indiana Department of Environmental Management



10900 South 88th Avenue
 Palos Hills, IL 60465-0937
 708-975-5415

Mary Ann Cook
 Instructional Coordinator

Mary Ann Cook



State of Illinois A 86367
 Department of Public Health

LICENSE, PERMIT, CERTIFICATION, REGISTRATION

The person, firm or corporation whose name appears on this certificate has complied with the provisions of the Illinois Statutes and/or rules and regulations and is hereby authorized to engage in the activity as indicated below.

JOHN R. LUMPKIN, M.D.
 DIRECTOR

Issued under the authority of
 The State of Illinois
 Department of Public Health

EXPIRATION DATE	CATEGORY	I.D. NUMBER
05/15/99	5319	100-3516
NICKOLAS BRIGLIO		
INSPECTOR AIR SAMPLING PROFESSIONAL		
MANAGEMENT PLANNER		
PROJECT MANAGER		

BUSINESS ADDRESS

ALTERING THIS CERTIFICATE MAY RESULT IN LEGAL ACTION

NICKOLAS BRIGLIO
 7903 WESTWOOD DRIVE IL 60635
 KILWOOD PARK

THIS LICENSE IS NOT VALID IF YOUR IDPH
 REFRESHER COURSE CERTIFICATE IS NOT CURRENT

Printed by Authority of the State of Illinois • 2/91 •

State of Illinois A 86367
 Department of Public Health
 LICENSE, PERMIT, CERTIFICATION, REGISTRATION
 ASBESTOS PROFESSIONAL LICENSE

EXPIRATION DATE	CATEGORY	I.D. NUMBER
05/15/99	5319	100-3516

NICKOLAS

BRIGLIO

INSPECTOR AIR SAMPLING PROFESSIONAL
 MANAGEMENT PLANNER
 PROJECT MANAGER



State of Illinois A 86261
 Department of Public Health

LICENSE, PERMIT, CERTIFICATION, REGISTRATION

The person, firm or corporation whose name appears on this certificate has complied with the provisions of the Illinois Statutes and/or rules and regulations and is hereby authorized to engage in the activity as indicated below.

JOHN R. LUMPKIN, M.D.
 DIRECTOR

Issued under the authority of
 The State of Illinois
 Department of Public Health

EXPIRATION DATE 05/15/99	CATEGORY 5319	I.D. NUMBER 100-0269
KURT GATES MANAGEMENT PLANNER PROJECT DESIGNER PROJECT MANAGER INSPECTOR AIR SAMPLING PROFESSIONAL		

BUSINESS ADDRESS

ALTERING THIS CERTIFICATE MAY RESULT IN LEGAL ACTION
 KURT
 GATES

6949 MORGAN COURT
 GURNEE IL 60031

THIS LICENSE IS NOT VALID IF YOUR IDPH
 REFRESHER COURSE CERTIFICATE IS NOT CURRENT

Printed by Authority of the State of Illinois • 2/91 •

Occupational Training & Supply, Inc.
12601 S. Springfield • Alsip, IL 60803 • 708/385-1325

Danial Gott
358-74-9073

has successfully completed the 24 hour Asbestos Building Inspector course and has passed the competency exam with a minimum score of 70%. This course is accredited by the Illinois Department of Public Health and Indiana Department of Environmental Management for purposes of accreditation in accordance with EPA 40 CFR 763, Asbestos Hazard Emergency Response Act (AHERA) and TSCA Title II.

Asbestos Building Inspector

Exam Date: June 26, 1998
Certificate: AB1986241801

Course Date: June 24-26, 1998
Expiration Date: June 26, 1999

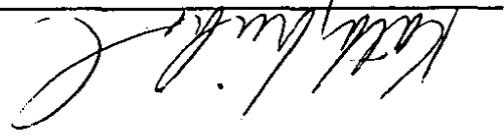
Kathy Nicholson, Director

1998





State of Illinois A 97614
 Department of Public Health

LICENSE, PERMIT, CERTIFICATION, REGISTRATION

The person, firm or corporation whose name appears on this certificate has complied with the provisions of the Illinois Statutes and/or rules and regulations and is hereby authorized to engage in the activity as indicated below.

JOHN R. LUMPKIN, M.D.
 DIRECTOR

Issued under the authority of
 The State of Illinois
 Department of Public Health

EXPIRATION DATE 05/15/2000	CATEGORY 5319	I.D. NUMBER 100-8428
DANIAL GOTT		
INSPECTOR AIR SAMPLING PROFESSIONAL PROJECT MANAGER		

BUSINESS ADDRESS
 ASBESTOS PROFESSIONAL LICENSE
 ALTERING THIS CERTIFICATE MAY RESULT IN LEGAL ACTION

DANIAL GOTT
 3645 N. SHEFFIELD AVENUE, #1
 CHICAGO IL 60613

THIS LICENSE IS NOT VALID IF YOUR IDPH
 COURSE CERTIFICATE IS NOT CURRENT

Printed by Authority of the State of Illinois • 2/91 •

State of Illinois A 97614
 Department of Public Health
 LICENSE, PERMIT, CERTIFICATION, REGISTRATION
 ASBESTOS PROFESSIONAL LICENSE

EXPIRATION DATE 05/15/2000	CATEGORY 5319	I.D. NUMBER 100-8428
-------------------------------	------------------	-------------------------

DANIAL GOTT

INSPECTOR AIR SAMPLING PROFESSIONAL
 PROJECT MANAGER

