

Illinois Capital Development Board

Art-in-Architecture

Request for Qualifications

Southern Illinois University

Transportation Education Center

Murphysboro, Illinois

Project Number: 825-020-143

CALL TO ARTISTS

The Art-in-Architecture (AIA) Program of the Capital Development Board (CDB) is pleased to announce a Request for Qualifications to Illinois professional artists to create permanent original public art for the Transportation Education Center at Southern Illinois University located in Murphysboro, Illinois.

Deadline: Friday, November 14, 2014
4:30 P.M.

ELIGIBILITY

These public art commissions and potential purchases are open to all professional artists, artisans, or artist-led teams *that live and work in the state of Illinois*.

An artist/artisan is defined as a skilled practitioner that generates designs and concepts for creative works that reflect form, beauty, and aesthetic perception. All artists on a team must be from Illinois.

Subcontractors may be used and are defined as those providing technical implementation such as construction, fabrication, and/or assembly for portions or all of a finished product under direct supervision and control of an artist.

Faculty, instructors, and staff of Southern Illinois University (SIU) as well as degree-seeking fine art students are not eligible to apply.

PROJECT SUMMARY

The School of Transportation in the College of Applied Sciences and Arts at SIU is a leader in the transportation field. Its programs in Automotive Technology, Aviation Flight and Management, and Aviation Technologies have been a source of pride for well over half a century. Prior to the construction of the TEC, aviation management and flight programs split instruction between facilities at the airport and campus buildings in Carbondale, with aviation technologies classes meeting at the airport. The automotive technology program had the bulk of its classes in World War II-era buildings on the University's Carterville campus, about 16 miles from the airport. The TEC brings the aviation and automotive programs together in a state-of-the-art facility at the Southern Illinois Airport.

For more information about the School of Transportation visit www.asa.siu.edu/academics/schools.html.

For more information about the Transportation Education Center visit www.rccllc.com/southern-illinois-university-transportation-education-center.

ARTISTIC OBJECTIVES

The committee is interested in statement artwork that addresses motion and changes in our concept of motion through time and space either through apparent or actual movement in the piece(s). While the committee has no preconceived ideas about media, in order for the piece to be durable, safe, and cost effective to maintain, media selections will be limited to non-porous materials such as plastics, metals, glass, stone, wood, brick, and tile. Soft permeable materials such as textiles and paper are not suitable for the environment.

Three potential areas have been identified for art and shown on the floor plans and site plans are:

- The front (north) exterior plaza,
- The main (north) lobby,
- The approximately 16' x 600' north/south hallway.



PROJECT SITE

The TEC is a 185,910 square foot facility, part of a three-building 228,000 gross square foot, ten-acre complex. The Test Cell Building and Fleet Storage Building complete the complex that is located at the Southern Illinois Airport approximately six miles from the main campus. The building is bisected by a main corridor. To the east of the corridor is a two-story office and administrative wing for faculty and students. To the west is a single-story structure that houses the automotive labs, flight simulator room, and weather dispatch center for the Aviation Flight program. At the south end of the corridor is a multi-purpose education area. The facility houses the School of Transportation's Automotive Technology, Aviation Flight, Aviation Management, and Aviation Technologies departments.

BUDGET DETAILS

The budget for the project is \$290,000.00.

This budget covers all expenses associated with, but not limited to the design proposals, project design, labor, fabrication, project management, materials, tools, contracted services, operations and meetings, and travel required to complete the artwork plus installation, related permits, licenses, and insurance, and transportation and delivery of the work to the site, as well as documentation of the completed project. Any expense that exceeds the contracted amount will be the artist's responsibility.

The artist is responsible for working with the Capital Development Board Art-in-Architecture Program, the using agency, and other relevant partners to oversee all aspects of the art installation.

SELECTION PROCESS

At least three artists/teams will be selected from the pool of eligible artists/teams and paid a fee of \$2,500.00 each to develop and present site specific project proposals. The artists/teams selected to provide proposals will be announced on the AIA website. Letters will also be sent to the selected artists/teams with details of the proposal process and contracts.

Do not send a proposal unless you have been contacted by the Art-in-Architecture Coordinator.

LEGAL AGREEMENT

The Capital Development Board Art-in-Architecture Program reserves the right to alter any aspect of the selection process or overall project in any way for its own convenience at any time. This Request

for Qualifications does not constitute either an expressed or implied contract and these provisions are subject to change.

CERTIFICATIONS AND DISCLOSURES

Board of Elections Certification

Under the Illinois Procurement Code you may be required to register as a business entity with the State Board of Elections (SBE). If an artist has existing contracts, has a contract for a design proposal on a project not yet awarded, or has a combination of existing contracts or proposals that in total will exceed \$50,000 with the state of Illinois, the artist is required to register with the SBE. You must register electronically by going to BEREP.elections.il.gov. You cannot register by mail, e-mail, or telephone.

HOW TO APPLY

IF YOU HAVE ALREADY APPLIED TO THE ILLINOIS ART-IN-ARCHITECTURE PROGRAM

You do not need to send a full package of materials again if you applied *after November 1, 2012*. To apply for this project submit a Letter of Intent that includes

- the project name and project number
- your name and the name of your team members if applying as a team
- your most current contact information including address, telephone number, and e-mail address

IF YOU HAVE NEVER APPLIED TO THE ILLINOIS ART-IN-ARCHITECTURE PROGRAM

Please e-mail or post a full package including ONE copy of each of the following *labeled with the artist's name as well as the project name and number*:

- *Résumé* (if a team, one for each member) with current contact information, including:
 - Name
 - Address
 - Phone
 - Fax
 - E-mail
 - Website
- *Artist Statement/Letter of Intent* (1 page maximum, double spaced)
 - If the submission is on behalf of a team, please identify the lead artist and indicate if the individuals have previously collaborated and the nature of the collaboration.

-
- If the artist or artist team has worked with not-for-profit organizations, local governments, state agencies, or other similar and relevant groups, please describe the project.
 - *Up to 15 JPEG images of relevant past work.* Please provide the images in the following format:
 - One image per JPEG
 - Pixel dimensions per image: approximately 600 x 800
 - Image resolution: 72–300 pixels per inch
 - Maximum file size per image: 1MB
 - Name each image: lastnamefirstnameimagenumber.jpg, for example: mirojoan01, mirojoan02, mirojoan03, etc.
 - A corresponding, numbered, annotated image list with title, media, dimensions, location, brief description, date of the work, project budget, and project partners, if applicable.
 - If submitting by e-mail, please send images as attachments and not in the body of the e-mail.
 - *References* of at least three professionals (commissioning agency or organization, design or arts professional, architect, landscape architect, engineer, etc.) who have a detailed knowledge of the artist's work and working methods. Include contact name, complete address, telephone number, and e-mail for each reference.
 - *Optional.* One PDF file of additional support material, including press clippings or other relevant information on past projects (maximum 1MB file.)
 - *Digital Submittals* If the information is provided on a CD, include the documents (resume, artist statement, image list, references, etc.) as well as the images, and label it clearly with artist or team name and date.
 - *PowerPoint presentations are not accepted.*

Please Note:

- Send art as JPEG files ONLY. Slides will not be accepted nor returned.
- **Do not send design proposals.**
- All submittals become property of the Capital Development Board Art-in-Architecture Program and will not be returned. Submissions can be made available for public viewing. The artist retains copyright.

HOW AND WHERE TO SUBMIT

Interested artists must send application materials by **Friday, November 14, 2014 at 4:30 P.M.**

Submissions received after this date will be kept for review for other Art-in-Architecture projects.

Application materials may be delivered by:

E-mail to **CDB.ArtinArchitecture@illinois.gov**

Hand delivery to address below

USPS or other mailing service to address below

Art-in-Architecture Program
Capital Development Board
Wm. G. Stratton Building, 3rd Floor
401 South Spring Street
Springfield, IL 62706

QUESTIONS?

Contact the Art-in-Architecture Program at **CDB.ArtinArchitecture@illinois.gov**

The Art-in-Architecture Procedure Manual, commission opportunities, and other information is posted at <http://www2.illinois.gov/cdb/services/art>

ABOUT THE ART-IN-ARCHITECTURE PROGRAM

The Illinois Art-in-Architecture Program promotes and preserves Illinois art and enriches communities by commissioning original artwork for public buildings constructed with State funds.

The enabling legislation for the Program requires that the Capital Development Board "shall set aside 1/2 of 1 percent of the amount authorized and appropriated for construction or reconstruction of each public building financed in whole or in part by State funds and generally accessible to and used by the public for purchase and placement of suitable works of art in such public buildings." A committee of artists, art professionals, architects, and community representatives oversee each project and select the artwork.

Since its inception in 1977, the Art-in-Architecture Program has purchased or commissioned over 1000 works of art by Illinois artists for public display throughout Illinois. For more information visit <http://www2.illinois.gov/cdb/services/art>.

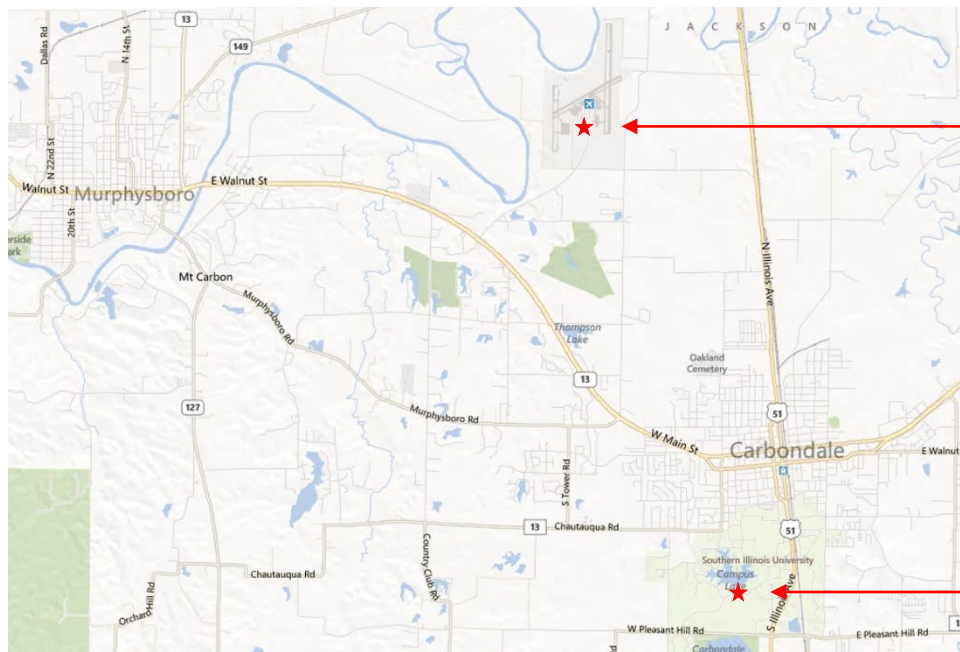

Transportation
Education Center at
Southern Illinois Airport

Southern Illinois
University Campus

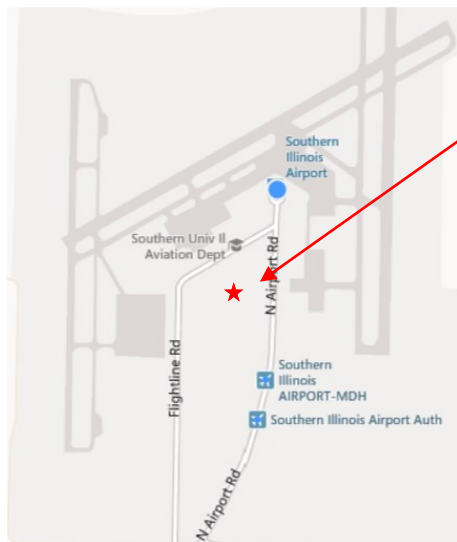

Transportation Education Center at
Southern Illinois Airport



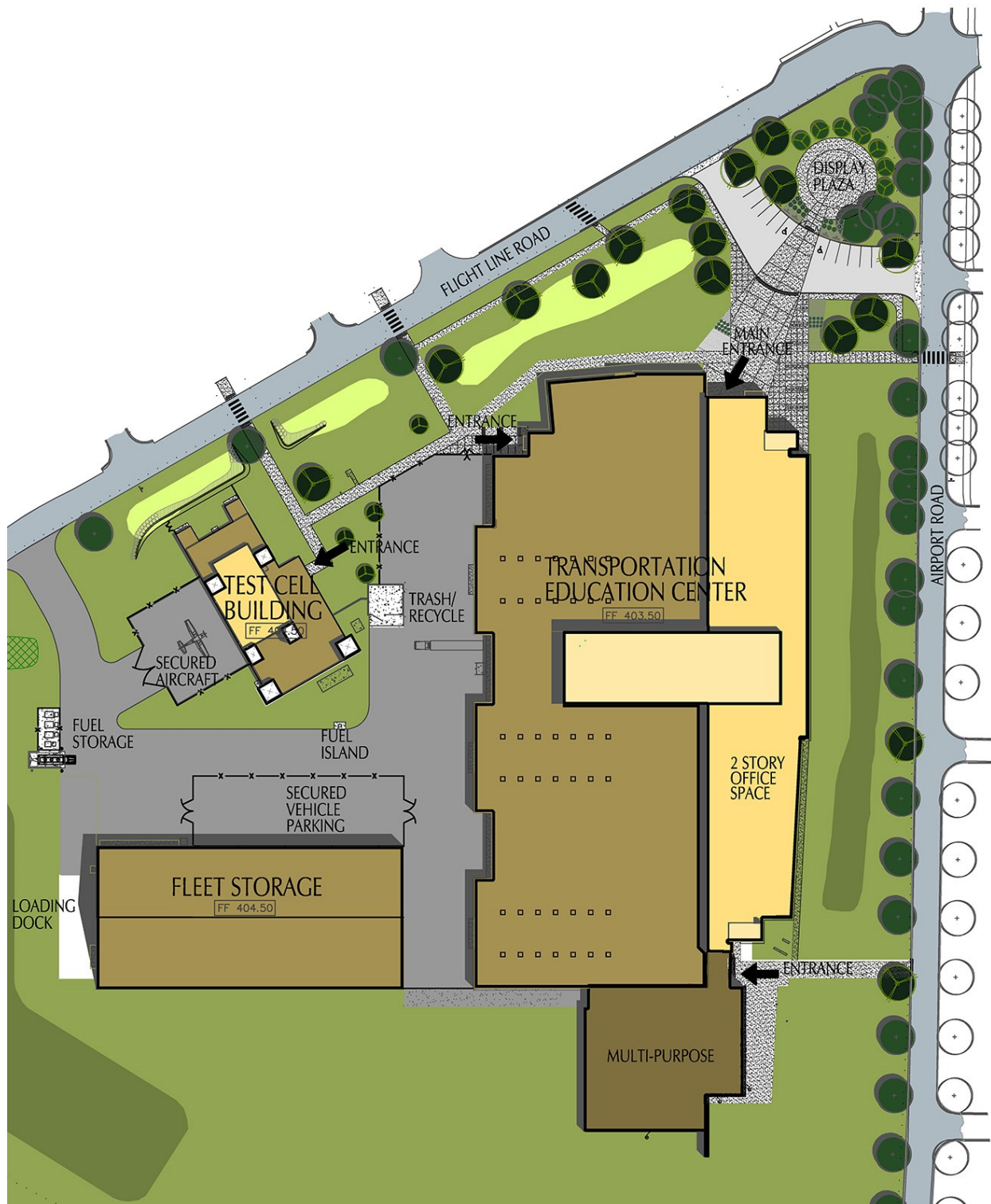



TEC FIRST FLOOR PLAN
SCALE: 1" = 20' 0" 10' 20' 40' 60'

FGM ARCHITECTS

CAPITAL DEVELOPMENT BOARD

State of Illinois
Pat Quinn, Governor

CONSTRUCT NEW TRANSPORTATION EDUCATION CENTER
SOUTHERN ILLINOIS UNIVERSITY CARBONDALE

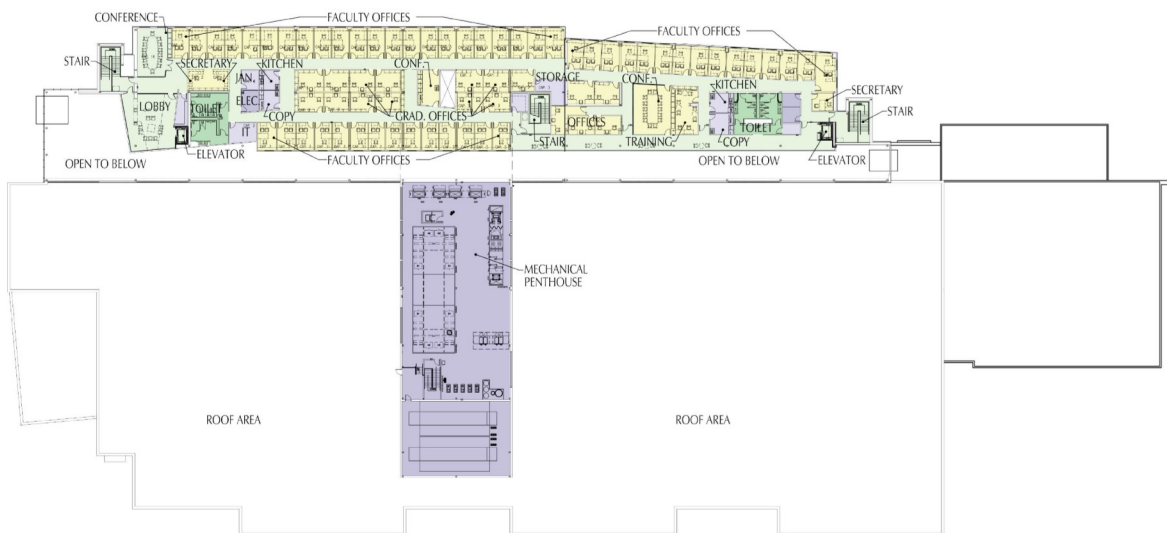

TEC SECOND FLOOR PLAN
SCALE: 1" = 20' 0" 10' 20' 40' 60'

FGM ARCHITECTS

CAPITAL DEVELOPMENT BOARD

State of Illinois
Pat Quinn, Governor

CONSTRUCT NEW TRANSPORTATION EDUCATION CENTER
SOUTHERN ILLINOIS UNIVERSITY CARBONDALE

SIU Transportation Education Center
Murphysboro, Illinois
825-020-143



Transportation Education Center, North Lobby Entrance



Transportation Education Center, Lobby



Transportation Education Center, Main Corridor looking north



Transportation Education Center, Main Corridor looking south



Transportation Education Center, Main Corridor looking south



Transportation Education Center, Main Corridor looking north